

Urbanline **Stenberg Lighting**
17 17 37 SQUARE BRASS ALUMINUM POLES (SBA)

| ITEM | DESCRIPTION | QTY | UNIT | PRICE | TOTAL |
|------|--|-----|------|--------|--------|
| 1 | 17 17 37 SQUARE BRASS ALUMINUM POLES (SBA) | 1 | EA | 100.00 | 100.00 |
| 2 | 17 17 37 SQUARE BRASS ALUMINUM POLES (SBA) | 1 | EA | 100.00 | 100.00 |
| 3 | 17 17 37 SQUARE BRASS ALUMINUM POLES (SBA) | 1 | EA | 100.00 | 100.00 |
| 4 | 17 17 37 SQUARE BRASS ALUMINUM POLES (SBA) | 1 | EA | 100.00 | 100.00 |
| 5 | 17 17 37 SQUARE BRASS ALUMINUM POLES (SBA) | 1 | EA | 100.00 | 100.00 |
| 6 | 17 17 37 SQUARE BRASS ALUMINUM POLES (SBA) | 1 | EA | 100.00 | 100.00 |
| 7 | 17 17 37 SQUARE BRASS ALUMINUM POLES (SBA) | 1 | EA | 100.00 | 100.00 |
| 8 | 17 17 37 SQUARE BRASS ALUMINUM POLES (SBA) | 1 | EA | 100.00 | 100.00 |
| 9 | 17 17 37 SQUARE BRASS ALUMINUM POLES (SBA) | 1 | EA | 100.00 | 100.00 |
| 10 | 17 17 37 SQUARE BRASS ALUMINUM POLES (SBA) | 1 | EA | 100.00 | 100.00 |

LIGHT POLE DETAIL
R15

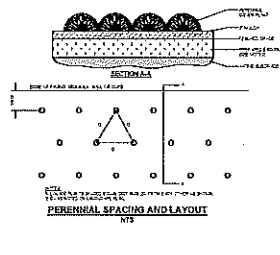
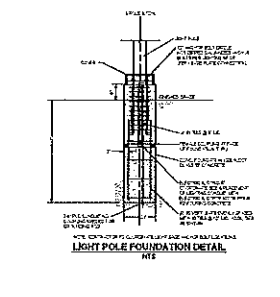

M1660 MILENA SERIES **R15**

| ITEM | DESCRIPTION | QTY | UNIT | PRICE | TOTAL |
|------|---------------------|-----|------|--------|--------|
| 1 | M1660 MILENA SERIES | 1 | EA | 100.00 | 100.00 |
| 2 | M1660 MILENA SERIES | 1 | EA | 100.00 | 100.00 |
| 3 | M1660 MILENA SERIES | 1 | EA | 100.00 | 100.00 |
| 4 | M1660 MILENA SERIES | 1 | EA | 100.00 | 100.00 |
| 5 | M1660 MILENA SERIES | 1 | EA | 100.00 | 100.00 |
| 6 | M1660 MILENA SERIES | 1 | EA | 100.00 | 100.00 |
| 7 | M1660 MILENA SERIES | 1 | EA | 100.00 | 100.00 |
| 8 | M1660 MILENA SERIES | 1 | EA | 100.00 | 100.00 |
| 9 | M1660 MILENA SERIES | 1 | EA | 100.00 | 100.00 |
| 10 | M1660 MILENA SERIES | 1 | EA | 100.00 | 100.00 |

M1660 MILENA SERIES **R15**

POST TOP LIGHT DETAIL
R15

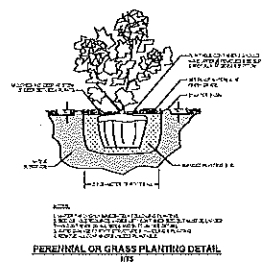
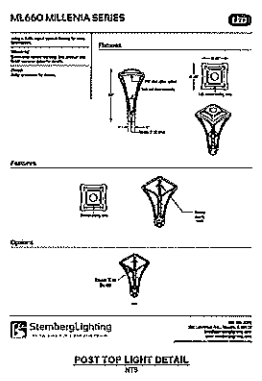

MILENA M1360 **R15**

| ITEM | DESCRIPTION | QTY | UNIT | PRICE | TOTAL |
|------|--------------|-----|------|--------|--------|
| 1 | MILENA M1360 | 1 | EA | 100.00 | 100.00 |
| 2 | MILENA M1360 | 1 | EA | 100.00 | 100.00 |
| 3 | MILENA M1360 | 1 | EA | 100.00 | 100.00 |
| 4 | MILENA M1360 | 1 | EA | 100.00 | 100.00 |
| 5 | MILENA M1360 | 1 | EA | 100.00 | 100.00 |
| 6 | MILENA M1360 | 1 | EA | 100.00 | 100.00 |
| 7 | MILENA M1360 | 1 | EA | 100.00 | 100.00 |
| 8 | MILENA M1360 | 1 | EA | 100.00 | 100.00 |
| 9 | MILENA M1360 | 1 | EA | 100.00 | 100.00 |
| 10 | MILENA M1360 | 1 | EA | 100.00 | 100.00 |

BOLLARD LIGHT DETAIL
R15

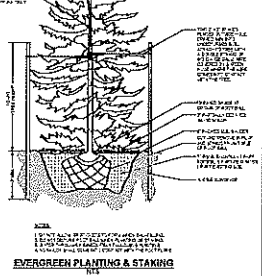
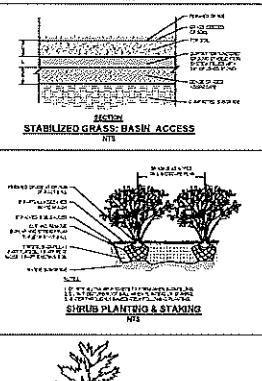

R15

| ITEM | DESCRIPTION | QTY | UNIT | PRICE | TOTAL |
|------|-------------|-----|------|--------|--------|
| 1 | R15 | 1 | EA | 100.00 | 100.00 |
| 2 | R15 | 1 | EA | 100.00 | 100.00 |
| 3 | R15 | 1 | EA | 100.00 | 100.00 |
| 4 | R15 | 1 | EA | 100.00 | 100.00 |
| 5 | R15 | 1 | EA | 100.00 | 100.00 |
| 6 | R15 | 1 | EA | 100.00 | 100.00 |
| 7 | R15 | 1 | EA | 100.00 | 100.00 |
| 8 | R15 | 1 | EA | 100.00 | 100.00 |
| 9 | R15 | 1 | EA | 100.00 | 100.00 |
| 10 | R15 | 1 | EA | 100.00 | 100.00 |

WALL MOUNTED LIGHT DETAIL
R15

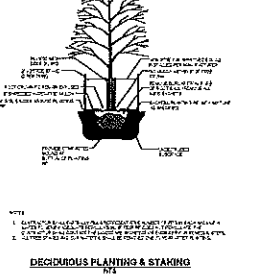
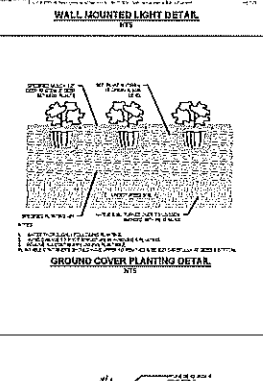

PROJECT INFORMATION

STONE RISE

APPLICANT'S PROFESSIONALS

REVISIONS

PRELIMINARY & FINAL MAJOR SITE PLAN

LANDSCAPE & LIGHTING DETAILS

C007

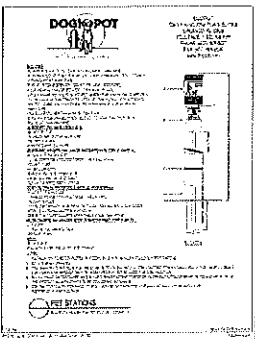

DOG WASTE STATION
R15

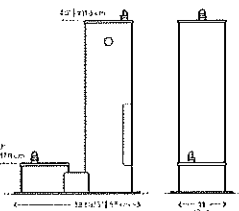

DOUBLE DRINKING FOUNTAIN
R15

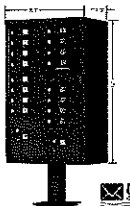

MAILBOX
R15

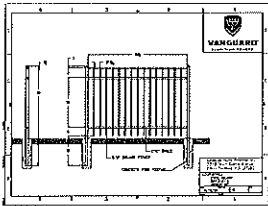

48 INCH ALUMINUM FENCE
R15

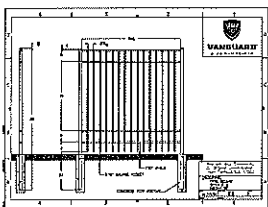

72 INCH ALUMINUM FENCE
R15

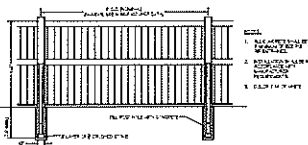

VINYL FENCE
R15

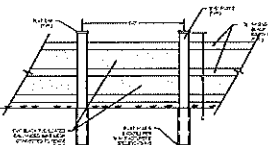

SMALL POST & RAIL BLACK VINYL FENCE
SURROUNDING INFILTRATION BASSIN
 R15



DOG PARK SURFACE
R15

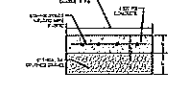

MAILBOX CONCRETE PAD
R15

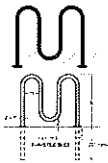

BIKE RACK
R15

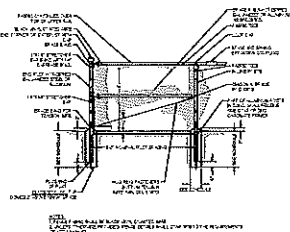

DOG RUN AND CHAIN LINK FENCING
DETAIL & SCHEDULE
 R15

PROJECT INFORMATION

STONE RISE

ARCHITECT
 NAME: [Redacted]
 ADDRESS: [Redacted]

CLIENT
 NAME: [Redacted]
 ADDRESS: [Redacted]

DATE
 01/24/2023

SCALE
 1/8" = 1'-0"

APPLICANT'S PROFESSIONALS

ARCHITECT
 NAME: [Redacted]
 ADDRESS: [Redacted]

ENGINEER
 NAME: [Redacted]
 ADDRESS: [Redacted]

LANDSCAPE ARCHITECT
 NAME: [Redacted]
 ADDRESS: [Redacted]

GENERAL CONTRACTOR
 NAME: [Redacted]
 ADDRESS: [Redacted]

PERMIT INFORMATION

PERMIT NO.
 [Redacted]

ISSUANCE DATE
 [Redacted]

EXPIRATION DATE
 [Redacted]

REVISIONS

NO. **DESCRIPTION** **DATE**

1 **ISSUED FOR PERMIT** **01/24/23**

2 **ISSUED FOR PERMIT** **01/24/23**

3 **ISSUED FOR PERMIT** **01/24/23**

4 **ISSUED FOR PERMIT** **01/24/23**

5 **ISSUED FOR PERMIT** **01/24/23**

6 **ISSUED FOR PERMIT** **01/24/23**

7 **ISSUED FOR PERMIT** **01/24/23**

8 **ISSUED FOR PERMIT** **01/24/23**

9 **ISSUED FOR PERMIT** **01/24/23**

10 **ISSUED FOR PERMIT** **01/24/23**

11 **ISSUED FOR PERMIT** **01/24/23**

12 **ISSUED FOR PERMIT** **01/24/23**

13 **ISSUED FOR PERMIT** **01/24/23**

14 **ISSUED FOR PERMIT** **01/24/23**

15 **ISSUED FOR PERMIT** **01/24/23**

16 **ISSUED FOR PERMIT** **01/24/23**

17 **ISSUED FOR PERMIT** **01/24/23**

18 **ISSUED FOR PERMIT** **01/24/23**

19 **ISSUED FOR PERMIT** **01/24/23**

20 **ISSUED FOR PERMIT** **01/24/23**

21 **ISSUED FOR PERMIT** **01/24/23**

22 **ISSUED FOR PERMIT** **01/24/23**

23 **ISSUED FOR PERMIT** **01/24/23**

24 **ISSUED FOR PERMIT** **01/24/23**

25 **ISSUED FOR PERMIT** **01/24/23**

26 **ISSUED FOR PERMIT** **01/24/23**

27 **ISSUED FOR PERMIT** **01/24/23**

28 **ISSUED FOR PERMIT** **01/24/23**

29 **ISSUED FOR PERMIT** **01/24/23**

30 **ISSUED FOR PERMIT** **01/24/23**

31 **ISSUED FOR PERMIT** **01/24/23**

32 **ISSUED FOR PERMIT** **01/24/23**

33 **ISSUED FOR PERMIT** **01/24/23**

34 **ISSUED FOR PERMIT** **01/24/23**

35 **ISSUED FOR PERMIT** **01/24/23**

36 **ISSUED FOR PERMIT** **01/24/23**

37 **ISSUED FOR PERMIT** **01/24/23**

38 **ISSUED FOR PERMIT** **01/24/23**

39 **ISSUED FOR PERMIT** **01/24/23**

40 **ISSUED FOR PERMIT** **01/24/23**

41 **ISSUED FOR PERMIT** **01/24/23**

42 **ISSUED FOR PERMIT** **01/24/23**

43 **ISSUED FOR PERMIT** **01/24/23**

44 **ISSUED FOR PERMIT** **01/24/23**

45 **ISSUED FOR PERMIT** **01/24/23**

46 **ISSUED FOR PERMIT** **01/24/23**

47 **ISSUED FOR PERMIT** **01/24/23**

48 **ISSUED FOR PERMIT** **01/24/23**

49 **ISSUED FOR PERMIT** **01/24/23**

50 **ISSUED FOR PERMIT** **01/24/23**

51 **ISSUED FOR PERMIT** **01/24/23**

52 **ISSUED FOR PERMIT** **01/24/23**

53 **ISSUED FOR PERMIT** **01/24/23**

54 **ISSUED FOR PERMIT** **01/24/23**

55 **ISSUED FOR PERMIT** **01/24/23**

56 **ISSUED FOR PERMIT** **01/24/23**

57 **ISSUED FOR PERMIT** **01/24/23**

58 **ISSUED FOR PERMIT** **01/24/23**

59 **ISSUED FOR PERMIT** **01/24/23**

60 **ISSUED FOR PERMIT** **01/24/23**

61 **ISSUED FOR PERMIT** **01/24/23**

62 **ISSUED FOR PERMIT** **01/24/23**

63 **ISSUED FOR PERMIT** **01/24/23**

64 **ISSUED FOR PERMIT** **01/24/23**

65 **ISSUED FOR PERMIT** **01/24/23**

66 **ISSUED FOR PERMIT** **01/24/23**

67 **ISSUED FOR PERMIT** **01/24/23**

68 **ISSUED FOR PERMIT** **01/24/23**

69 **ISSUED FOR PERMIT** **01/24/23**

70 **ISSUED FOR PERMIT** **01/24/23**

71 **ISSUED FOR PERMIT** **01/24/23**

72 **ISSUED FOR PERMIT** **01/24/23**

73 **ISSUED FOR PERMIT** **01/24/23**

74 **ISSUED FOR PERMIT** **01/24/23**

75 **ISSUED FOR PERMIT** **01/24/23**

76 **ISSUED FOR PERMIT** **01/24/23**

77 **ISSUED FOR PERMIT** **01/24/23**

78 **ISSUED FOR PERMIT** **01/24/23**

79 **ISSUED FOR PERMIT** **01/24/23**

80 **ISSUED FOR PERMIT** **01/24/23**

81 **ISSUED FOR PERMIT** **01/24/23**

82 **ISSUED FOR PERMIT** **01/24/23**

83 **ISSUED FOR PERMIT** **01/24/23**

84 **ISSUED FOR PERMIT** **01/24/23**

85 **ISSUED FOR PERMIT** **01/24/23**

86 **ISSUED FOR PERMIT** **01/24/23**

87 **ISSUED FOR PERMIT** **01/24/23**

88 **ISSUED FOR PERMIT** **01/24/23**

89 **ISSUED FOR PERMIT** **01/24/23**

90 **ISSUED FOR PERMIT** **01/24/23**

91 **ISSUED FOR PERMIT** **01/24/23**

92 **ISSUED FOR PERMIT** **01/24/23**

93 **ISSUED FOR PERMIT** **01/24/23**

94 **ISSUED FOR PERMIT** **01/24/23**

95 **ISSUED FOR PERMIT** **01/24/23**

96 **ISSUED FOR PERMIT** **01/24/23**

97 **ISSUED FOR PERMIT** **01/24/23**

98 **ISSUED FOR PERMIT** **01/24/23**

99 **ISSUED FOR PERMIT** **01/24/23**

100 **ISSUED FOR PERMIT** **01/24/23**

PRELIMINARY & FINAL
ILLUSTRATION PLAN

LANDSCAPE & LIGHTING
DETAILS

DATE
 02/28

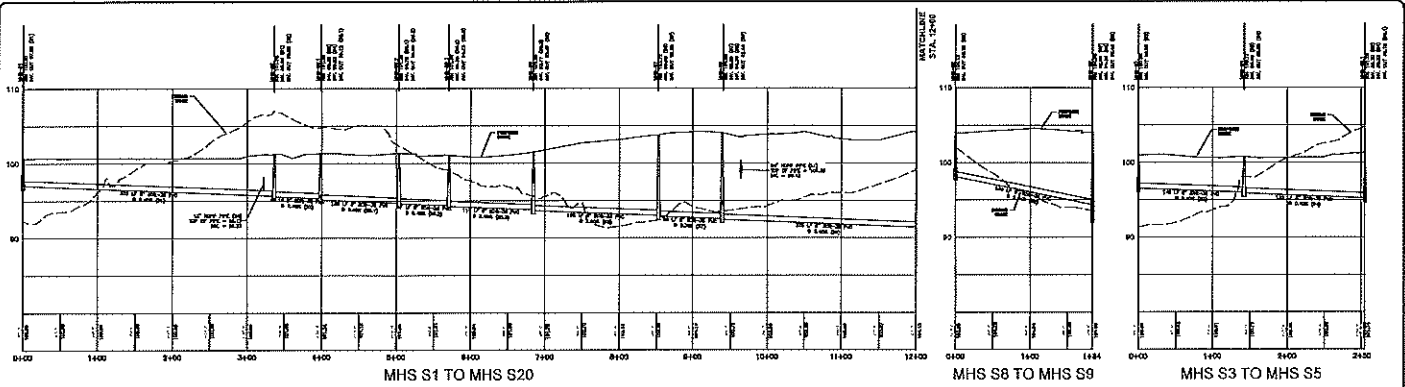

MHS S1 TO MHS S20

MHS S8 TO MHS S9

MHS S3 TO MHS S5

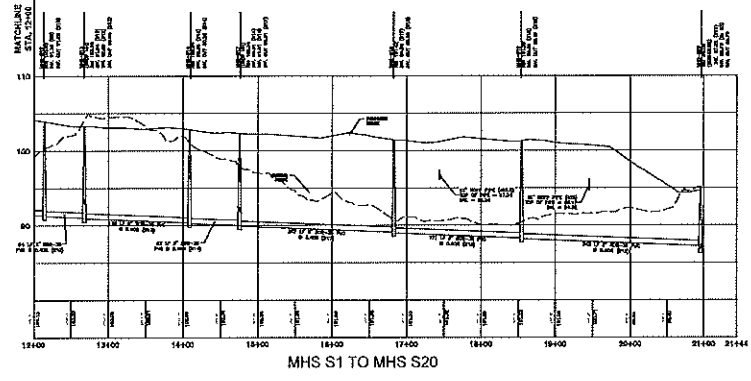

MHS S1 TO MHS S20

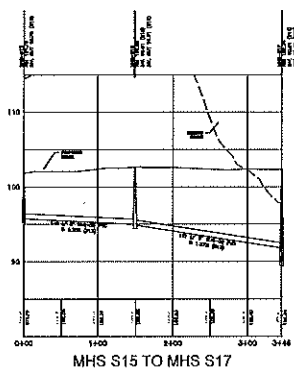

MHS S15 TO MHS S17

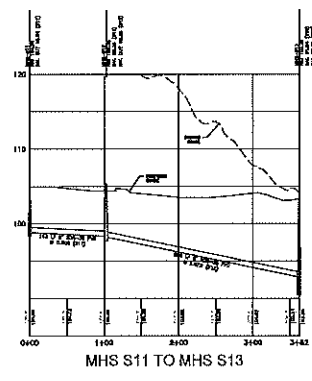

MHS S11 TO MHS S13



| SYMBOL | DESCRIPTION | SYMBOL | DESCRIPTION |
|----------|-------------|--------|-------------|
| (Symbol) | 18\"/> | | |

FINAL FOR SEWER DESIGN

PROJECT INFORMATION

STONE RISE

DATE: 10/15/10
 DRAWN BY: J. B. BROWN
 CHECKED BY: J. B. BROWN
 PROJECT NO: 10-10-10-10
 SHEET NO: 10-10-10-10

DESIGNER'S PROFESSIONAL SEAL

IN SITE

REVISIONS

| NO. | DATE | DESCRIPTION |
|-----|----------|-------------------------------------|
| 1 | 10/15/10 | PRELIMINARY & FINAL MAJOR SITE PLAN |

PROFILES

SCALE: 1" = 10'

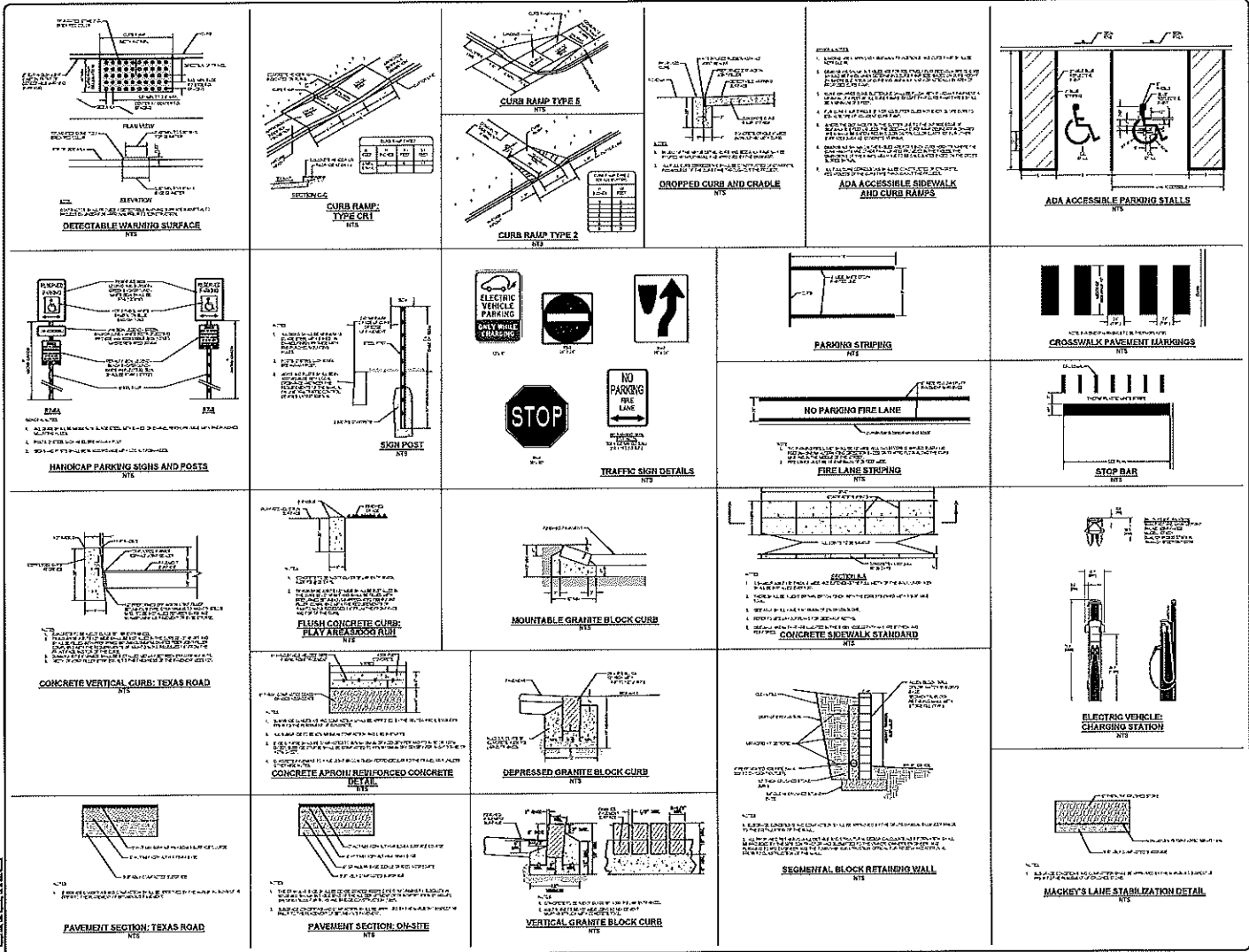

| PROJECT EXPLANATION | | | | | | | | | | | | | | | | | | | | | | | | | | | | | | | | | | | | | | | | | | | | | | | | | | | | | | | | | | | | | | | | | | | | | | | | | | | | | | | | | | | | | | | | | | | | | | | | | | | | | | | | | | | | | | | | | | | | | | | | | | | | | | | | | | | | | | | | | | | | | | | | | | | | | | | | | |
|---|------------|-------------------|-------------|---|------------|-------------------|---|------------|-------------------|---|------------|-------------------|---|------------|-------------------|---|------------|-------------------|---|------------|-------------------|---|------------|-------------------|---|------------|-------------------|---|------------|-------------------|----|------------|-------------------|----|------------|-------------------|----|------------|-------------------|----|------------|-------------------|----|------------|-------------------|----|------------|-------------------|----|------------|-------------------|----|------------|-------------------|----|------------|-------------------|----|------------|-------------------|----|------------|-------------------|----|------------|-------------------|----|------------|-------------------|----|------------|-------------------|----|------------|-------------------|----|------------|-------------------|----|------------|-------------------|----|------------|-------------------|----|------------|-------------------|----|------------|-------------------|----|------------|-------------------|----|------------|-------------------|----|------------|-------------------|----|------------|-------------------|----|------------|-------------------|----|------------|-------------------|----|------------|-------------------|----|------------|-------------------|----|------------|-------------------|----|------------|-------------------|----|------------|-------------------|----|------------|-------------------|----|------------|-------------------|----|------------|-------------------|----|------------|-------------------|----|------------|-------------------|----|------------|-------------------|----|------------|-------------------|----|------------|-------------------|----|------------|-------------------|----|------------|-------------------|
| STONE RISE | | | | | | | | | | | | | | | | | | | | | | | | | | | | | | | | | | | | | | | | | | | | | | | | | | | | | | | | | | | | | | | | | | | | | | | | | | | | | | | | | | | | | | | | | | | | | | | | | | | | | | | | | | | | | | | | | | | | | | | | | | | | | | | | | | | | | | | | | | | | | | | | | | | | | | | | | |
| <p>1. STONE RISE SHALL BE USED AT ALL CURB RAMP LOCATIONS.</p> <p>2. STONE RISE SHALL BE USED AT ALL CURB RAMP LOCATIONS.</p> <p>3. STONE RISE SHALL BE USED AT ALL CURB RAMP LOCATIONS.</p> | | | | | | | | | | | | | | | | | | | | | | | | | | | | | | | | | | | | | | | | | | | | | | | | | | | | | | | | | | | | | | | | | | | | | | | | | | | | | | | | | | | | | | | | | | | | | | | | | | | | | | | | | | | | | | | | | | | | | | | | | | | | | | | | | | | | | | | | | | | | | | | | | | | | | | | | | |
| REVISIONS | | | | | | | | | | | | | | | | | | | | | | | | | | | | | | | | | | | | | | | | | | | | | | | | | | | | | | | | | | | | | | | | | | | | | | | | | | | | | | | | | | | | | | | | | | | | | | | | | | | | | | | | | | | | | | | | | | | | | | | | | | | | | | | | | | | | | | | | | | | | | | | | | | | | | | | | | |
| <table border="1"> <tr> <th>NO.</th> <th>DATE</th> <th>DESCRIPTION</th> </tr> <tr> <td>1</td> <td>11/11/2020</td> <td>ISSUED FOR PERMIT</td> </tr> <tr> <td>2</td> <td>11/11/2020</td> <td>ISSUED FOR PERMIT</td> </tr> <tr> <td>3</td> <td>11/11/2020</td> <td>ISSUED FOR PERMIT</td> </tr> <tr> <td>4</td> <td>11/11/2020</td> <td>ISSUED FOR PERMIT</td> </tr> <tr> <td>5</td> <td>11/11/2020</td> <td>ISSUED FOR PERMIT</td> </tr> <tr> <td>6</td> <td>11/11/2020</td> <td>ISSUED FOR PERMIT</td> </tr> <tr> <td>7</td> <td>11/11/2020</td> <td>ISSUED FOR PERMIT</td> </tr> <tr> <td>8</td> <td>11/11/2020</td> <td>ISSUED FOR PERMIT</td> </tr> <tr> <td>9</td> <td>11/11/2020</td> <td>ISSUED FOR PERMIT</td> </tr> <tr> <td>10</td> <td>11/11/2020</td> <td>ISSUED FOR PERMIT</td> </tr> <tr> <td>11</td> <td>11/11/2020</td> <td>ISSUED FOR PERMIT</td> </tr> <tr> <td>12</td> <td>11/11/2020</td> <td>ISSUED FOR PERMIT</td> </tr> <tr> <td>13</td> <td>11/11/2020</td> <td>ISSUED FOR PERMIT</td> </tr> <tr> <td>14</td> <td>11/11/2020</td> <td>ISSUED FOR PERMIT</td> </tr> <tr> <td>15</td> <td>11/11/2020</td> <td>ISSUED FOR PERMIT</td> </tr> <tr> <td>16</td> <td>11/11/2020</td> <td>ISSUED FOR PERMIT</td> </tr> <tr> <td>17</td> <td>11/11/2020</td> <td>ISSUED FOR PERMIT</td> </tr> <tr> <td>18</td> <td>11/11/2020</td> <td>ISSUED FOR PERMIT</td> </tr> <tr> <td>19</td> <td>11/11/2020</td> <td>ISSUED FOR PERMIT</td> </tr> <tr> <td>20</td> <td>11/11/2020</td> <td>ISSUED FOR PERMIT</td> </tr> <tr> <td>21</td> <td>11/11/2020</td> <td>ISSUED FOR PERMIT</td> </tr> <tr> <td>22</td> <td>11/11/2020</td> <td>ISSUED FOR PERMIT</td> </tr> <tr> <td>23</td> <td>11/11/2020</td> <td>ISSUED FOR PERMIT</td> </tr> <tr> <td>24</td> <td>11/11/2020</td> <td>ISSUED FOR PERMIT</td> </tr> <tr> <td>25</td> <td>11/11/2020</td> <td>ISSUED FOR PERMIT</td> </tr> <tr> <td>26</td> <td>11/11/2020</td> <td>ISSUED FOR PERMIT</td> </tr> <tr> <td>27</td> <td>11/11/2020</td> <td>ISSUED FOR PERMIT</td> </tr> <tr> <td>28</td> <td>11/11/2020</td> <td>ISSUED FOR PERMIT</td> </tr> <tr> <td>29</td> <td>11/11/2020</td> <td>ISSUED FOR PERMIT</td> </tr> <tr> <td>30</td> <td>11/11/2020</td> <td>ISSUED FOR PERMIT</td> </tr> <tr> <td>31</td> <td>11/11/2020</td> <td>ISSUED FOR PERMIT</td> </tr> <tr> <td>32</td> <td>11/11/2020</td> <td>ISSUED FOR PERMIT</td> </tr> <tr> <td>33</td> <td>11/11/2020</td> <td>ISSUED FOR PERMIT</td> </tr> <tr> <td>34</td> <td>11/11/2020</td> <td>ISSUED FOR PERMIT</td> </tr> <tr> <td>35</td> <td>11/11/2020</td> <td>ISSUED FOR PERMIT</td> </tr> <tr> <td>36</td> <td>11/11/2020</td> <td>ISSUED FOR PERMIT</td> </tr> <tr> <td>37</td> <td>11/11/2020</td> <td>ISSUED FOR PERMIT</td> </tr> <tr> <td>38</td> <td>11/11/2020</td> <td>ISSUED FOR PERMIT</td> </tr> <tr> <td>39</td> <td>11/11/2020</td> <td>ISSUED FOR PERMIT</td> </tr> <tr> <td>40</td> <td>11/11/2020</td> <td>ISSUED FOR PERMIT</td> </tr> <tr> <td>41</td> <td>11/11/2020</td> <td>ISSUED FOR PERMIT</td> </tr> <tr> <td>42</td> <td>11/11/2020</td> <td>ISSUED FOR PERMIT</td> </tr> <tr> <td>43</td> <td>11/11/2020</td> <td>ISSUED FOR PERMIT</td> </tr> <tr> <td>44</td> <td>11/11/2020</td> <td>ISSUED FOR PERMIT</td> </tr> <tr> <td>45</td> <td>11/11/2020</td> <td>ISSUED FOR PERMIT</td> </tr> <tr> <td>46</td> <td>11/11/2020</td> <td>ISSUED FOR PERMIT</td> </tr> <tr> <td>47</td> <td>11/11/2020</td> <td>ISSUED FOR PERMIT</td> </tr> <tr> <td>48</td> <td>11/11/2020</td> <td>ISSUED FOR PERMIT</td> </tr> <tr> <td>49</td> <td>11/11/2020</td> <td>ISSUED FOR PERMIT</td> </tr> <tr> <td>50</td> <td>11/11/2020</td> <td>ISSUED FOR PERMIT</td> </tr> </table> | NO. | DATE | DESCRIPTION | 1 | 11/11/2020 | ISSUED FOR PERMIT | 2 | 11/11/2020 | ISSUED FOR PERMIT | 3 | 11/11/2020 | ISSUED FOR PERMIT | 4 | 11/11/2020 | ISSUED FOR PERMIT | 5 | 11/11/2020 | ISSUED FOR PERMIT | 6 | 11/11/2020 | ISSUED FOR PERMIT | 7 | 11/11/2020 | ISSUED FOR PERMIT | 8 | 11/11/2020 | ISSUED FOR PERMIT | 9 | 11/11/2020 | ISSUED FOR PERMIT | 10 | 11/11/2020 | ISSUED FOR PERMIT | 11 | 11/11/2020 | ISSUED FOR PERMIT | 12 | 11/11/2020 | ISSUED FOR PERMIT | 13 | 11/11/2020 | ISSUED FOR PERMIT | 14 | 11/11/2020 | ISSUED FOR PERMIT | 15 | 11/11/2020 | ISSUED FOR PERMIT | 16 | 11/11/2020 | ISSUED FOR PERMIT | 17 | 11/11/2020 | ISSUED FOR PERMIT | 18 | 11/11/2020 | ISSUED FOR PERMIT | 19 | 11/11/2020 | ISSUED FOR PERMIT | 20 | 11/11/2020 | ISSUED FOR PERMIT | 21 | 11/11/2020 | ISSUED FOR PERMIT | 22 | 11/11/2020 | ISSUED FOR PERMIT | 23 | 11/11/2020 | ISSUED FOR PERMIT | 24 | 11/11/2020 | ISSUED FOR PERMIT | 25 | 11/11/2020 | ISSUED FOR PERMIT | 26 | 11/11/2020 | ISSUED FOR PERMIT | 27 | 11/11/2020 | ISSUED FOR PERMIT | 28 | 11/11/2020 | ISSUED FOR PERMIT | 29 | 11/11/2020 | ISSUED FOR PERMIT | 30 | 11/11/2020 | ISSUED FOR PERMIT | 31 | 11/11/2020 | ISSUED FOR PERMIT | 32 | 11/11/2020 | ISSUED FOR PERMIT | 33 | 11/11/2020 | ISSUED FOR PERMIT | 34 | 11/11/2020 | ISSUED FOR PERMIT | 35 | 11/11/2020 | ISSUED FOR PERMIT | 36 | 11/11/2020 | ISSUED FOR PERMIT | 37 | 11/11/2020 | ISSUED FOR PERMIT | 38 | 11/11/2020 | ISSUED FOR PERMIT | 39 | 11/11/2020 | ISSUED FOR PERMIT | 40 | 11/11/2020 | ISSUED FOR PERMIT | 41 | 11/11/2020 | ISSUED FOR PERMIT | 42 | 11/11/2020 | ISSUED FOR PERMIT | 43 | 11/11/2020 | ISSUED FOR PERMIT | 44 | 11/11/2020 | ISSUED FOR PERMIT | 45 | 11/11/2020 | ISSUED FOR PERMIT | 46 | 11/11/2020 | ISSUED FOR PERMIT | 47 | 11/11/2020 | ISSUED FOR PERMIT | 48 | 11/11/2020 | ISSUED FOR PERMIT | 49 | 11/11/2020 | ISSUED FOR PERMIT | 50 | 11/11/2020 | ISSUED FOR PERMIT |
| NO. | DATE | DESCRIPTION | | | | | | | | | | | | | | | | | | | | | | | | | | | | | | | | | | | | | | | | | | | | | | | | | | | | | | | | | | | | | | | | | | | | | | | | | | | | | | | | | | | | | | | | | | | | | | | | | | | | | | | | | | | | | | | | | | | | | | | | | | | | | | | | | | | | | | | | | | | | | | | | | | | | | | | |
| 1 | 11/11/2020 | ISSUED FOR PERMIT | | | | | | | | | | | | | | | | | | | | | | | | | | | | | | | | | | | | | | | | | | | | | | | | | | | | | | | | | | | | | | | | | | | | | | | | | | | | | | | | | | | | | | | | | | | | | | | | | | | | | | | | | | | | | | | | | | | | | | | | | | | | | | | | | | | | | | | | | | | | | | | | | | | | | | | |
| 2 | 11/11/2020 | ISSUED FOR PERMIT | | | | | | | | | | | | | | | | | | | | | | | | | | | | | | | | | | | | | | | | | | | | | | | | | | | | | | | | | | | | | | | | | | | | | | | | | | | | | | | | | | | | | | | | | | | | | | | | | | | | | | | | | | | | | | | | | | | | | | | | | | | | | | | | | | | | | | | | | | | | | | | | | | | | | | | |
| 3 | 11/11/2020 | ISSUED FOR PERMIT | | | | | | | | | | | | | | | | | | | | | | | | | | | | | | | | | | | | | | | | | | | | | | | | | | | | | | | | | | | | | | | | | | | | | | | | | | | | | | | | | | | | | | | | | | | | | | | | | | | | | | | | | | | | | | | | | | | | | | | | | | | | | | | | | | | | | | | | | | | | | | | | | | | | | | | |
| 4 | 11/11/2020 | ISSUED FOR PERMIT | | | | | | | | | | | | | | | | | | | | | | | | | | | | | | | | | | | | | | | | | | | | | | | | | | | | | | | | | | | | | | | | | | | | | | | | | | | | | | | | | | | | | | | | | | | | | | | | | | | | | | | | | | | | | | | | | | | | | | | | | | | | | | | | | | | | | | | | | | | | | | | | | | | | | | | |
| 5 | 11/11/2020 | ISSUED FOR PERMIT | | | | | | | | | | | | | | | | | | | | | | | | | | | | | | | | | | | | | | | | | | | | | | | | | | | | | | | | | | | | | | | | | | | | | | | | | | | | | | | | | | | | | | | | | | | | | | | | | | | | | | | | | | | | | | | | | | | | | | | | | | | | | | | | | | | | | | | | | | | | | | | | | | | | | | | |
| 6 | 11/11/2020 | ISSUED FOR PERMIT | | | | | | | | | | | | | | | | | | | | | | | | | | | | | | | | | | | | | | | | | | | | | | | | | | | | | | | | | | | | | | | | | | | | | | | | | | | | | | | | | | | | | | | | | | | | | | | | | | | | | | | | | | | | | | | | | | | | | | | | | | | | | | | | | | | | | | | | | | | | | | | | | | | | | | | |
| 7 | 11/11/2020 | ISSUED FOR PERMIT | | | | | | | | | | | | | | | | | | | | | | | | | | | | | | | | | | | | | | | | | | | | | | | | | | | | | | | | | | | | | | | | | | | | | | | | | | | | | | | | | | | | | | | | | | | | | | | | | | | | | | | | | | | | | | | | | | | | | | | | | | | | | | | | | | | | | | | | | | | | | | | | | | | | | | | |
| 8 | 11/11/2020 | ISSUED FOR PERMIT | | | | | | | | | | | | | | | | | | | | | | | | | | | | | | | | | | | | | | | | | | | | | | | | | | | | | | | | | | | | | | | | | | | | | | | | | | | | | | | | | | | | | | | | | | | | | | | | | | | | | | | | | | | | | | | | | | | | | | | | | | | | | | | | | | | | | | | | | | | | | | | | | | | | | | | |
| 9 | 11/11/2020 | ISSUED FOR PERMIT | | | | | | | | | | | | | | | | | | | | | | | | | | | | | | | | | | | | | | | | | | | | | | | | | | | | | | | | | | | | | | | | | | | | | | | | | | | | | | | | | | | | | | | | | | | | | | | | | | | | | | | | | | | | | | | | | | | | | | | | | | | | | | | | | | | | | | | | | | | | | | | | | | | | | | | |
| 10 | 11/11/2020 | ISSUED FOR PERMIT | | | | | | | | | | | | | | | | | | | | | | | | | | | | | | | | | | | | | | | | | | | | | | | | | | | | | | | | | | | | | | | | | | | | | | | | | | | | | | | | | | | | | | | | | | | | | | | | | | | | | | | | | | | | | | | | | | | | | | | | | | | | | | | | | | | | | | | | | | | | | | | | | | | | | | | |
| 11 | 11/11/2020 | ISSUED FOR PERMIT | | | | | | | | | | | | | | | | | | | | | | | | | | | | | | | | | | | | | | | | | | | | | | | | | | | | | | | | | | | | | | | | | | | | | | | | | | | | | | | | | | | | | | | | | | | | | | | | | | | | | | | | | | | | | | | | | | | | | | | | | | | | | | | | | | | | | | | | | | | | | | | | | | | | | | | |
| 12 | 11/11/2020 | ISSUED FOR PERMIT | | | | | | | | | | | | | | | | | | | | | | | | | | | | | | | | | | | | | | | | | | | | | | | | | | | | | | | | | | | | | | | | | | | | | | | | | | | | | | | | | | | | | | | | | | | | | | | | | | | | | | | | | | | | | | | | | | | | | | | | | | | | | | | | | | | | | | | | | | | | | | | | | | | | | | | |
| 13 | 11/11/2020 | ISSUED FOR PERMIT | | | | | | | | | | | | | | | | | | | | | | | | | | | | | | | | | | | | | | | | | | | | | | | | | | | | | | | | | | | | | | | | | | | | | | | | | | | | | | | | | | | | | | | | | | | | | | | | | | | | | | | | | | | | | | | | | | | | | | | | | | | | | | | | | | | | | | | | | | | | | | | | | | | | | | | |
| 14 | 11/11/2020 | ISSUED FOR PERMIT | | | | | | | | | | | | | | | | | | | | | | | | | | | | | | | | | | | | | | | | | | | | | | | | | | | | | | | | | | | | | | | | | | | | | | | | | | | | | | | | | | | | | | | | | | | | | | | | | | | | | | | | | | | | | | | | | | | | | | | | | | | | | | | | | | | | | | | | | | | | | | | | | | | | | | | |
| 15 | 11/11/2020 | ISSUED FOR PERMIT | | | | | | | | | | | | | | | | | | | | | | | | | | | | | | | | | | | | | | | | | | | | | | | | | | | | | | | | | | | | | | | | | | | | | | | | | | | | | | | | | | | | | | | | | | | | | | | | | | | | | | | | | | | | | | | | | | | | | | | | | | | | | | | | | | | | | | | | | | | | | | | | | | | | | | | |
| 16 | 11/11/2020 | ISSUED FOR PERMIT | | | | | | | | | | | | | | | | | | | | | | | | | | | | | | | | | | | | | | | | | | | | | | | | | | | | | | | | | | | | | | | | | | | | | | | | | | | | | | | | | | | | | | | | | | | | | | | | | | | | | | | | | | | | | | | | | | | | | | | | | | | | | | | | | | | | | | | | | | | | | | | | | | | | | | | |
| 17 | 11/11/2020 | ISSUED FOR PERMIT | | | | | | | | | | | | | | | | | | | | | | | | | | | | | | | | | | | | | | | | | | | | | | | | | | | | | | | | | | | | | | | | | | | | | | | | | | | | | | | | | | | | | | | | | | | | | | | | | | | | | | | | | | | | | | | | | | | | | | | | | | | | | | | | | | | | | | | | | | | | | | | | | | | | | | | |
| 18 | 11/11/2020 | ISSUED FOR PERMIT | | | | | | | | | | | | | | | | | | | | | | | | | | | | | | | | | | | | | | | | | | | | | | | | | | | | | | | | | | | | | | | | | | | | | | | | | | | | | | | | | | | | | | | | | | | | | | | | | | | | | | | | | | | | | | | | | | | | | | | | | | | | | | | | | | | | | | | | | | | | | | | | | | | | | | | |
| 19 | 11/11/2020 | ISSUED FOR PERMIT | | | | | | | | | | | | | | | | | | | | | | | | | | | | | | | | | | | | | | | | | | | | | | | | | | | | | | | | | | | | | | | | | | | | | | | | | | | | | | | | | | | | | | | | | | | | | | | | | | | | | | | | | | | | | | | | | | | | | | | | | | | | | | | | | | | | | | | | | | | | | | | | | | | | | | | |
| 20 | 11/11/2020 | ISSUED FOR PERMIT | | | | | | | | | | | | | | | | | | | | | | | | | | | | | | | | | | | | | | | | | | | | | | | | | | | | | | | | | | | | | | | | | | | | | | | | | | | | | | | | | | | | | | | | | | | | | | | | | | | | | | | | | | | | | | | | | | | | | | | | | | | | | | | | | | | | | | | | | | | | | | | | | | | | | | | |
| 21 | 11/11/2020 | ISSUED FOR PERMIT | | | | | | | | | | | | | | | | | | | | | | | | | | | | | | | | | | | | | | | | | | | | | | | | | | | | | | | | | | | | | | | | | | | | | | | | | | | | | | | | | | | | | | | | | | | | | | | | | | | | | | | | | | | | | | | | | | | | | | | | | | | | | | | | | | | | | | | | | | | | | | | | | | | | | | | |
| 22 | 11/11/2020 | ISSUED FOR PERMIT | | | | | | | | | | | | | | | | | | | | | | | | | | | | | | | | | | | | | | | | | | | | | | | | | | | | | | | | | | | | | | | | | | | | | | | | | | | | | | | | | | | | | | | | | | | | | | | | | | | | | | | | | | | | | | | | | | | | | | | | | | | | | | | | | | | | | | | | | | | | | | | | | | | | | | | |
| 23 | 11/11/2020 | ISSUED FOR PERMIT | | | | | | | | | | | | | | | | | | | | | | | | | | | | | | | | | | | | | | | | | | | | | | | | | | | | | | | | | | | | | | | | | | | | | | | | | | | | | | | | | | | | | | | | | | | | | | | | | | | | | | | | | | | | | | | | | | | | | | | | | | | | | | | | | | | | | | | | | | | | | | | | | | | | | | | |
| 24 | 11/11/2020 | ISSUED FOR PERMIT | | | | | | | | | | | | | | | | | | | | | | | | | | | | | | | | | | | | | | | | | | | | | | | | | | | | | | | | | | | | | | | | | | | | | | | | | | | | | | | | | | | | | | | | | | | | | | | | | | | | | | | | | | | | | | | | | | | | | | | | | | | | | | | | | | | | | | | | | | | | | | | | | | | | | | | |
| 25 | 11/11/2020 | ISSUED FOR PERMIT | | | | | | | | | | | | | | | | | | | | | | | | | | | | | | | | | | | | | | | | | | | | | | | | | | | | | | | | | | | | | | | | | | | | | | | | | | | | | | | | | | | | | | | | | | | | | | | | | | | | | | | | | | | | | | | | | | | | | | | | | | | | | | | | | | | | | | | | | | | | | | | | | | | | | | | |
| 26 | 11/11/2020 | ISSUED FOR PERMIT | | | | | | | | | | | | | | | | | | | | | | | | | | | | | | | | | | | | | | | | | | | | | | | | | | | | | | | | | | | | | | | | | | | | | | | | | | | | | | | | | | | | | | | | | | | | | | | | | | | | | | | | | | | | | | | | | | | | | | | | | | | | | | | | | | | | | | | | | | | | | | | | | | | | | | | |
| 27 | 11/11/2020 | ISSUED FOR PERMIT | | | | | | | | | | | | | | | | | | | | | | | | | | | | | | | | | | | | | | | | | | | | | | | | | | | | | | | | | | | | | | | | | | | | | | | | | | | | | | | | | | | | | | | | | | | | | | | | | | | | | | | | | | | | | | | | | | | | | | | | | | | | | | | | | | | | | | | | | | | | | | | | | | | | | | | |
| 28 | 11/11/2020 | ISSUED FOR PERMIT | | | | | | | | | | | | | | | | | | | | | | | | | | | | | | | | | | | | | | | | | | | | | | | | | | | | | | | | | | | | | | | | | | | | | | | | | | | | | | | | | | | | | | | | | | | | | | | | | | | | | | | | | | | | | | | | | | | | | | | | | | | | | | | | | | | | | | | | | | | | | | | | | | | | | | | |
| 29 | 11/11/2020 | ISSUED FOR PERMIT | | | | | | | | | | | | | | | | | | | | | | | | | | | | | | | | | | | | | | | | | | | | | | | | | | | | | | | | | | | | | | | | | | | | | | | | | | | | | | | | | | | | | | | | | | | | | | | | | | | | | | | | | | | | | | | | | | | | | | | | | | | | | | | | | | | | | | | | | | | | | | | | | | | | | | | |
| 30 | 11/11/2020 | ISSUED FOR PERMIT | | | | | | | | | | | | | | | | | | | | | | | | | | | | | | | | | | | | | | | | | | | | | | | | | | | | | | | | | | | | | | | | | | | | | | | | | | | | | | | | | | | | | | | | | | | | | | | | | | | | | | | | | | | | | | | | | | | | | | | | | | | | | | | | | | | | | | | | | | | | | | | | | | | | | | | |
| 31 | 11/11/2020 | ISSUED FOR PERMIT | | | | | | | | | | | | | | | | | | | | | | | | | | | | | | | | | | | | | | | | | | | | | | | | | | | | | | | | | | | | | | | | | | | | | | | | | | | | | | | | | | | | | | | | | | | | | | | | | | | | | | | | | | | | | | | | | | | | | | | | | | | | | | | | | | | | | | | | | | | | | | | | | | | | | | | |
| 32 | 11/11/2020 | ISSUED FOR PERMIT | | | | | | | | | | | | | | | | | | | | | | | | | | | | | | | | | | | | | | | | | | | | | | | | | | | | | | | | | | | | | | | | | | | | | | | | | | | | | | | | | | | | | | | | | | | | | | | | | | | | | | | | | | | | | | | | | | | | | | | | | | | | | | | | | | | | | | | | | | | | | | | | | | | | | | | |
| 33 | 11/11/2020 | ISSUED FOR PERMIT | | | | | | | | | | | | | | | | | | | | | | | | | | | | | | | | | | | | | | | | | | | | | | | | | | | | | | | | | | | | | | | | | | | | | | | | | | | | | | | | | | | | | | | | | | | | | | | | | | | | | | | | | | | | | | | | | | | | | | | | | | | | | | | | | | | | | | | | | | | | | | | | | | | | | | | |
| 34 | 11/11/2020 | ISSUED FOR PERMIT | | | | | | | | | | | | | | | | | | | | | | | | | | | | | | | | | | | | | | | | | | | | | | | | | | | | | | | | | | | | | | | | | | | | | | | | | | | | | | | | | | | | | | | | | | | | | | | | | | | | | | | | | | | | | | | | | | | | | | | | | | | | | | | | | | | | | | | | | | | | | | | | | | | | | | | |
| 35 | 11/11/2020 | ISSUED FOR PERMIT | | | | | | | | | | | | | | | | | | | | | | | | | | | | | | | | | | | | | | | | | | | | | | | | | | | | | | | | | | | | | | | | | | | | | | | | | | | | | | | | | | | | | | | | | | | | | | | | | | | | | | | | | | | | | | | | | | | | | | | | | | | | | | | | | | | | | | | | | | | | | | | | | | | | | | | |
| 36 | 11/11/2020 | ISSUED FOR PERMIT | | | | | | | | | | | | | | | | | | | | | | | | | | | | | | | | | | | | | | | | | | | | | | | | | | | | | | | | | | | | | | | | | | | | | | | | | | | | | | | | | | | | | | | | | | | | | | | | | | | | | | | | | | | | | | | | | | | | | | | | | | | | | | | | | | | | | | | | | | | | | | | | | | | | | | | |
| 37 | 11/11/2020 | ISSUED FOR PERMIT | | | | | | | | | | | | | | | | | | | | | | | | | | | | | | | | | | | | | | | | | | | | | | | | | | | | | | | | | | | | | | | | | | | | | | | | | | | | | | | | | | | | | | | | | | | | | | | | | | | | | | | | | | | | | | | | | | | | | | | | | | | | | | | | | | | | | | | | | | | | | | | | | | | | | | | |
| 38 | 11/11/2020 | ISSUED FOR PERMIT | | | | | | | | | | | | | | | | | | | | | | | | | | | | | | | | | | | | | | | | | | | | | | | | | | | | | | | | | | | | | | | | | | | | | | | | | | | | | | | | | | | | | | | | | | | | | | | | | | | | | | | | | | | | | | | | | | | | | | | | | | | | | | | | | | | | | | | | | | | | | | | | | | | | | | | |
| 39 | 11/11/2020 | ISSUED FOR PERMIT | | | | | | | | | | | | | | | | | | | | | | | | | | | | | | | | | | | | | | | | | | | | | | | | | | | | | | | | | | | | | | | | | | | | | | | | | | | | | | | | | | | | | | | | | | | | | | | | | | | | | | | | | | | | | | | | | | | | | | | | | | | | | | | | | | | | | | | | | | | | | | | | | | | | | | | |
| 40 | 11/11/2020 | ISSUED FOR PERMIT | | | | | | | | | | | | | | | | | | | | | | | | | | | | | | | | | | | | | | | | | | | | | | | | | | | | | | | | | | | | | | | | | | | | | | | | | | | | | | | | | | | | | | | | | | | | | | | | | | | | | | | | | | | | | | | | | | | | | | | | | | | | | | | | | | | | | | | | | | | | | | | | | | | | | | | |
| 41 | 11/11/2020 | ISSUED FOR PERMIT | | | | | | | | | | | | | | | | | | | | | | | | | | | | | | | | | | | | | | | | | | | | | | | | | | | | | | | | | | | | | | | | | | | | | | | | | | | | | | | | | | | | | | | | | | | | | | | | | | | | | | | | | | | | | | | | | | | | | | | | | | | | | | | | | | | | | | | | | | | | | | | | | | | | | | | |
| 42 | 11/11/2020 | ISSUED FOR PERMIT | | | | | | | | | | | | | | | | | | | | | | | | | | | | | | | | | | | | | | | | | | | | | | | | | | | | | | | | | | | | | | | | | | | | | | | | | | | | | | | | | | | | | | | | | | | | | | | | | | | | | | | | | | | | | | | | | | | | | | | | | | | | | | | | | | | | | | | | | | | | | | | | | | | | | | | |
| 43 | 11/11/2020 | ISSUED FOR PERMIT | | | | | | | | | | | | | | | | | | | | | | | | | | | | | | | | | | | | | | | | | | | | | | | | | | | | | | | | | | | | | | | | | | | | | | | | | | | | | | | | | | | | | | | | | | | | | | | | | | | | | | | | | | | | | | | | | | | | | | | | | | | | | | | | | | | | | | | | | | | | | | | | | | | | | | | |
| 44 | 11/11/2020 | ISSUED FOR PERMIT | | | | | | | | | | | | | | | | | | | | | | | | | | | | | | | | | | | | | | | | | | | | | | | | | | | | | | | | | | | | | | | | | | | | | | | | | | | | | | | | | | | | | | | | | | | | | | | | | | | | | | | | | | | | | | | | | | | | | | | | | | | | | | | | | | | | | | | | | | | | | | | | | | | | | | | |
| 45 | 11/11/2020 | ISSUED FOR PERMIT | | | | | | | | | | | | | | | | | | | | | | | | | | | | | | | | | | | | | | | | | | | | | | | | | | | | | | | | | | | | | | | | | | | | | | | | | | | | | | | | | | | | | | | | | | | | | | | | | | | | | | | | | | | | | | | | | | | | | | | | | | | | | | | | | | | | | | | | | | | | | | | | | | | | | | | |
| 46 | 11/11/2020 | ISSUED FOR PERMIT | | | | | | | | | | | | | | | | | | | | | | | | | | | | | | | | | | | | | | | | | | | | | | | | | | | | | | | | | | | | | | | | | | | | | | | | | | | | | | | | | | | | | | | | | | | | | | | | | | | | | | | | | | | | | | | | | | | | | | | | | | | | | | | | | | | | | | | | | | | | | | | | | | | | | | | |
| 47 | 11/11/2020 | ISSUED FOR PERMIT | | | | | | | | | | | | | | | | | | | | | | | | | | | | | | | | | | | | | | | | | | | | | | | | | | | | | | | | | | | | | | | | | | | | | | | | | | | | | | | | | | | | | | | | | | | | | | | | | | | | | | | | | | | | | | | | | | | | | | | | | | | | | | | | | | | | | | | | | | | | | | | | | | | | | | | |
| 48 | 11/11/2020 | ISSUED FOR PERMIT | | | | | | | | | | | | | | | | | | | | | | | | | | | | | | | | | | | | | | | | | | | | | | | | | | | | | | | | | | | | | | | | | | | | | | | | | | | | | | | | | | | | | | | | | | | | | | | | | | | | | | | | | | | | | | | | | | | | | | | | | | | | | | | | | | | | | | | | | | | | | | | | | | | | | | | |
| 49 | 11/11/2020 | ISSUED FOR PERMIT | | | | | | | | | | | | | | | | | | | | | | | | | | | | | | | | | | | | | | | | | | | | | | | | | | | | | | | | | | | | | | | | | | | | | | | | | | | | | | | | | | | | | | | | | | | | | | | | | | | | | | | | | | | | | | | | | | | | | | | | | | | | | | | | | | | | | | | | | | | | | | | | | | | | | | | |
| 50 | 11/11/2020 | ISSUED FOR PERMIT | | | | | | | | | | | | | | | | | | | | | | | | | | | | | | | | | | | | | | | | | | | | | | | | | | | | | | | | | | | | | | | | | | | | | | | | | | | | | | | | | | | | | | | | | | | | | | | | | | | | | | | | | | | | | | | | | | | | | | | | | | | | | | | | | | | | | | | | | | | | | | | | | | | | | | | |
| PRELIMINARY & FINAL MAJOR SITE PLAN | | | | | | | | | | | | | | | | | | | | | | | | | | | | | | | | | | | | | | | | | | | | | | | | | | | | | | | | | | | | | | | | | | | | | | | | | | | | | | | | | | | | | | | | | | | | | | | | | | | | | | | | | | | | | | | | | | | | | | | | | | | | | | | | | | | | | | | | | | | | | | | | | | | | | | | | | |
| CONSTRUCTION DETAILS | | | | | | | | | | | | | | | | | | | | | | | | | | | | | | | | | | | | | | | | | | | | | | | | | | | | | | | | | | | | | | | | | | | | | | | | | | | | | | | | | | | | | | | | | | | | | | | | | | | | | | | | | | | | | | | | | | | | | | | | | | | | | | | | | | | | | | | | | | | | | | | | | | | | | | | | | |
| C500 | | | | | | | | | | | | | | | | | | | | | | | | | | | | | | | | | | | | | | | | | | | | | | | | | | | | | | | | | | | | | | | | | | | | | | | | | | | | | | | | | | | | | | | | | | | | | | | | | | | | | | | | | | | | | | | | | | | | | | | | | | | | | | | | | | | | | | | | | | | | | | | | | | | | | | | | | |

| | |
|--|---------------|
| PROJECT INFORMATION | |
| STONE RISE | |
| DATE | NOVEMBER 2011 |
| SCALE | AS SHOWN |
| DESIGNER | PERKINS+WILL |
| ENGINEER | PERKINS+WILL |
| ARCHITECT | PERKINS+WILL |
| CONSULTANT | PERKINS+WILL |
| CLIENT | PERKINS+WILL |
| LOCATION | PERKINS+WILL |
| PROJECT NO. | PERKINS+WILL |
|  | |
| PROJECT MANAGER PROJECT ARCHITECT PROJECT ENGINEER PROJECT CONSULTANT PROJECT CLIENT | |
| PRELIMINARY & FINAL MAJOR SITE PLAN CONSTRUCTION DETAILS | |
| SHEET NO. OF | |

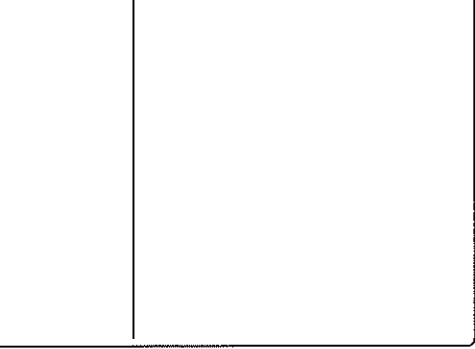
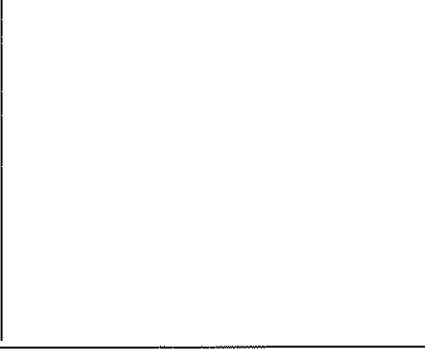
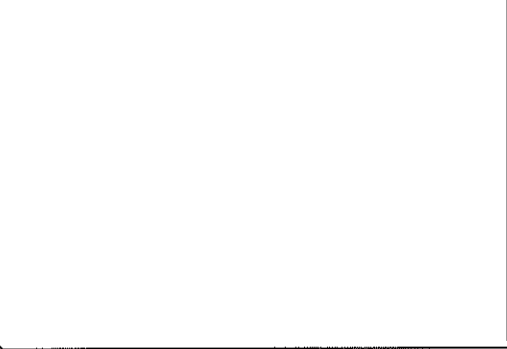
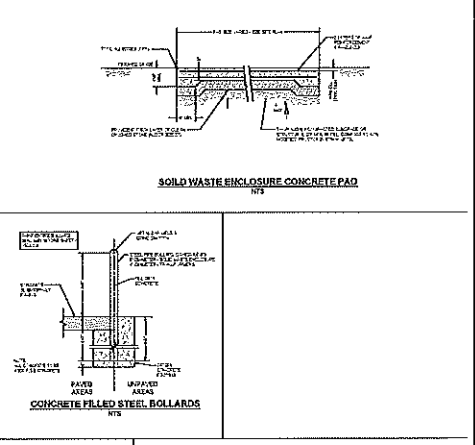
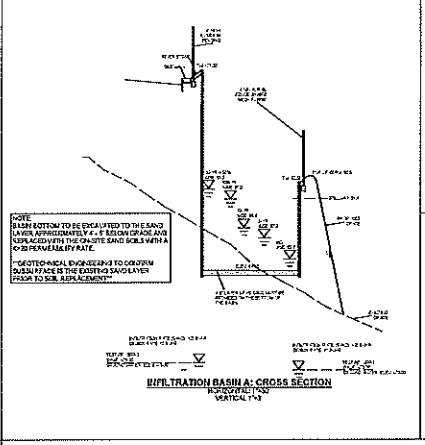
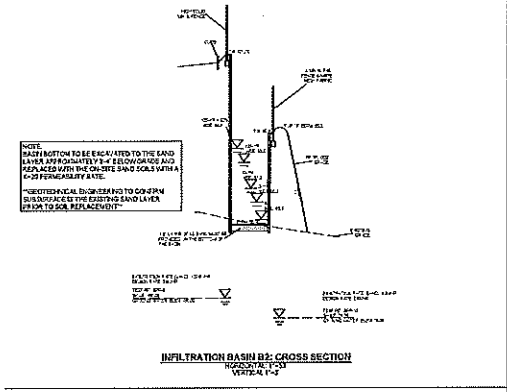
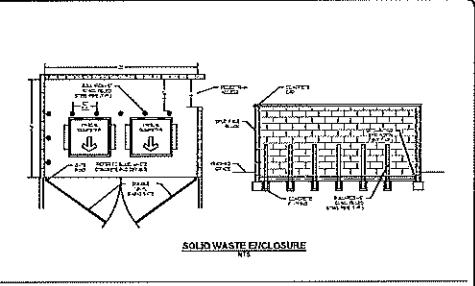
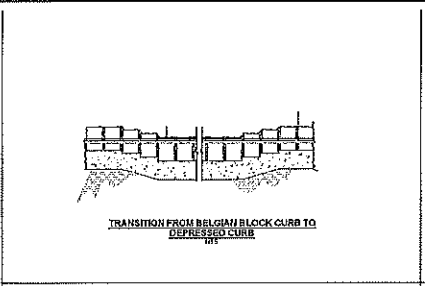
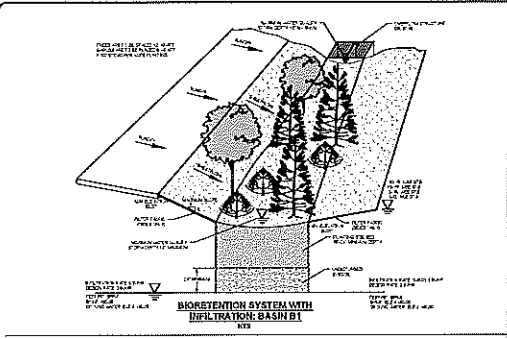

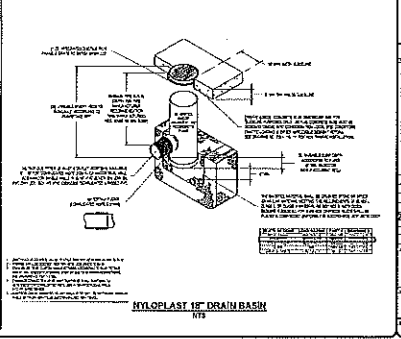
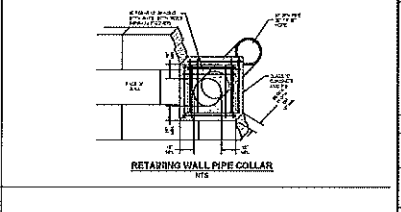
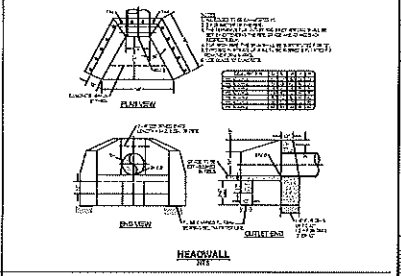
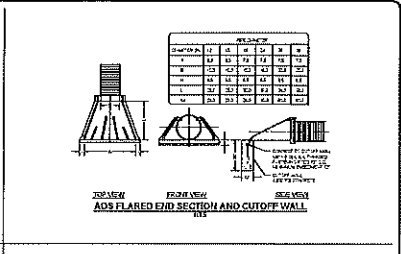
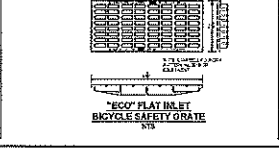
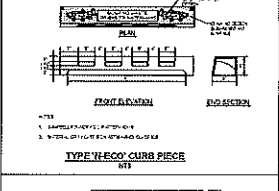
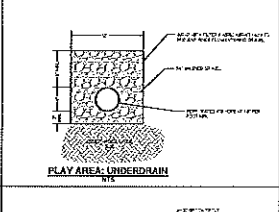
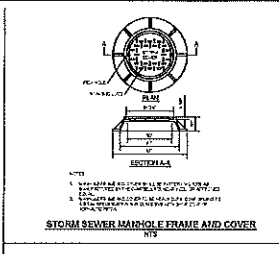
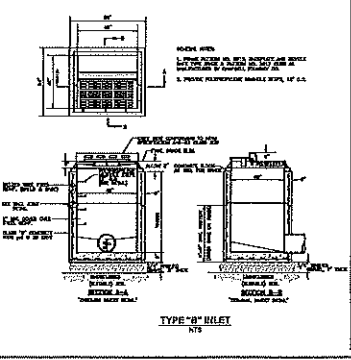
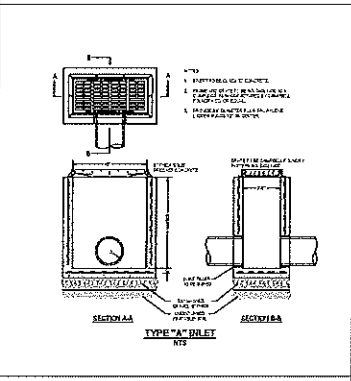
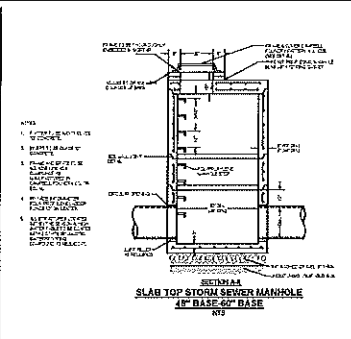
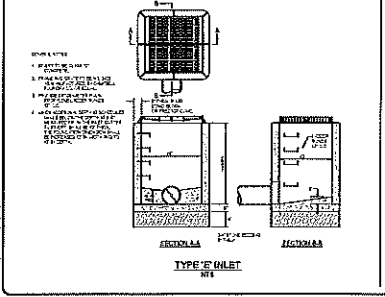
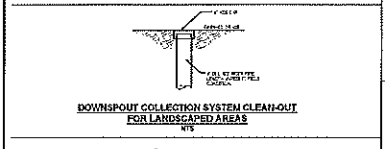
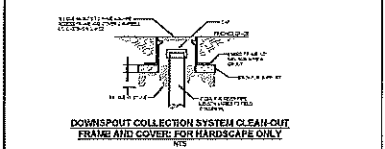
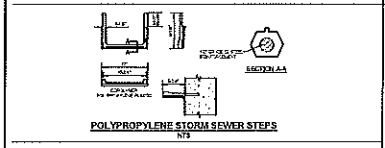
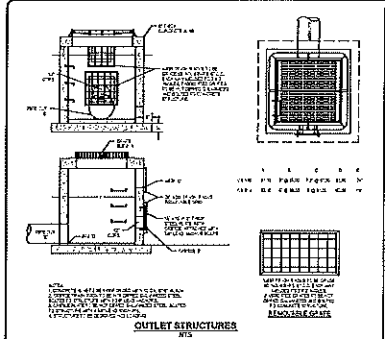

PROJECT INFORMATION

STONE RISE

DATE: 10/15/2024

SCALE: 1/4" = 1'-0"

DESIGNED BY: [Name]

CHECKED BY: [Name]

APPROVED BY: [Name]

PROJECT NO: [Number]

REVISIONS

| NO. | DESCRIPTION | DATE |
|-----|-------------------------|------------|
| 1 | ISSUED FOR PERMIT | 10/15/2024 |
| 2 | ISSUED FOR CONSTRUCTION | 10/15/2024 |

PRELIMINARY & FINAL MAJOR SITE PLAN

CONSTRUCTION DETAILS

SCALE: C492

WRAPIDSEAL™

JOINT PROTECTION WITH



CCI PIPELINE SYSTEMS

THE PROFESSIONAL

MANHOLE ENGAGEMENT PROTECTION DETAIL NTS

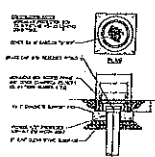

MONUMENT BOX ACCESS COVER DETAILS

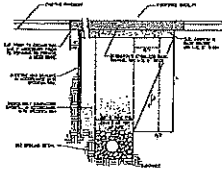

TRENCH AND TEMPORARY PAVEMENT REPAIR

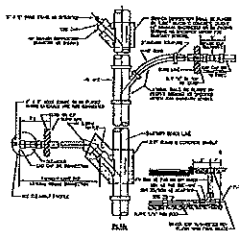

CONCRETE MANHOLE

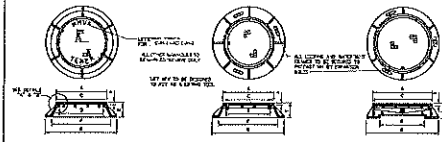

TYPICAL MANHOLE FRAME AND COVER

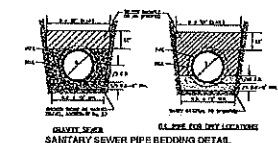

SANITARY SEWER PIPE BEDDING DETAIL

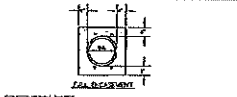

CONCRETE ENGAGEMENT

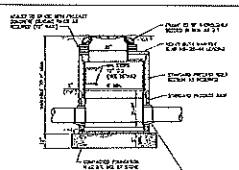

BRANCH AND LATERAL HOUSE CONNECTION

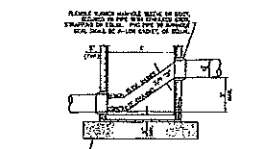

CURB MANHOLE

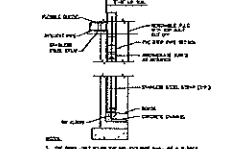

INTERIOR DROP CONNECTION

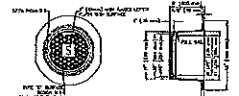

STANDARD SHALLOW MANHOLE

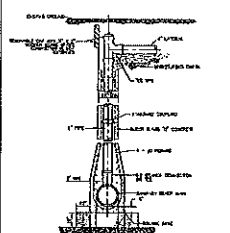

DEEP HOUSE CONNECTION

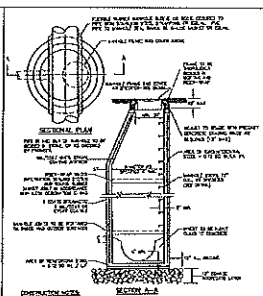

STANDARD PRECAST SANITARY MANHOLE

GENERAL NOTES:

1. THE DESIGNER SHALL PROVIDE THE BEST AVAILABLE MATERIALS AND METHODS OF CONSTRUCTION TO BE USED FOR ALL WORK AND SHALL BE RESPONSIBLE FOR THE QUALITY OF THE WORK.
2. THE DESIGNER SHALL ALSO BE RESPONSIBLE FOR PROVIDING ALL NECESSARY CONSTRUCTION DETAILS TO BE USED FOR THE CONSTRUCTION OF ALL WORK.
3. THE DESIGNER SHALL ALSO BE RESPONSIBLE FOR PROVIDING ALL NECESSARY CONSTRUCTION DETAILS TO BE USED FOR THE CONSTRUCTION OF ALL WORK.
4. ALL WORK SHALL BE DONE IN ACCORDANCE WITH THE LATEST EDITIONS OF THE STANDARD SPECIFICATIONS FOR HIGHWAY CONSTRUCTION AND THE STANDARD SPECIFICATIONS FOR WATERWAYS CONSTRUCTION.
5. ALL WORK SHALL BE DONE IN ACCORDANCE WITH THE LATEST EDITIONS OF THE STANDARD SPECIFICATIONS FOR HIGHWAY CONSTRUCTION AND THE STANDARD SPECIFICATIONS FOR WATERWAYS CONSTRUCTION.
6. ALL WORK SHALL BE DONE IN ACCORDANCE WITH THE LATEST EDITIONS OF THE STANDARD SPECIFICATIONS FOR HIGHWAY CONSTRUCTION AND THE STANDARD SPECIFICATIONS FOR WATERWAYS CONSTRUCTION.
7. ALL WORK SHALL BE DONE IN ACCORDANCE WITH THE LATEST EDITIONS OF THE STANDARD SPECIFICATIONS FOR HIGHWAY CONSTRUCTION AND THE STANDARD SPECIFICATIONS FOR WATERWAYS CONSTRUCTION.
8. ALL WORK SHALL BE DONE IN ACCORDANCE WITH THE LATEST EDITIONS OF THE STANDARD SPECIFICATIONS FOR HIGHWAY CONSTRUCTION AND THE STANDARD SPECIFICATIONS FOR WATERWAYS CONSTRUCTION.
9. ALL WORK SHALL BE DONE IN ACCORDANCE WITH THE LATEST EDITIONS OF THE STANDARD SPECIFICATIONS FOR HIGHWAY CONSTRUCTION AND THE STANDARD SPECIFICATIONS FOR WATERWAYS CONSTRUCTION.
10. ALL WORK SHALL BE DONE IN ACCORDANCE WITH THE LATEST EDITIONS OF THE STANDARD SPECIFICATIONS FOR HIGHWAY CONSTRUCTION AND THE STANDARD SPECIFICATIONS FOR WATERWAYS CONSTRUCTION.

FINAL FOR SEWER DESIGN

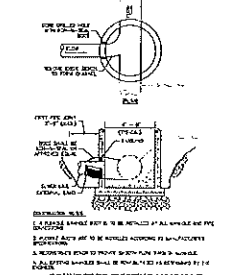

CONNECT TO EXISTING MANHOLE

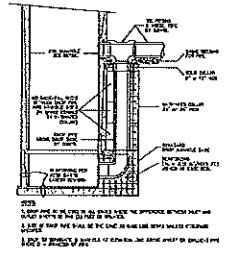

TYPICAL DROP CONNECTION

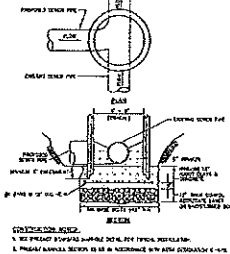

DOGHOUSE MANHOLE

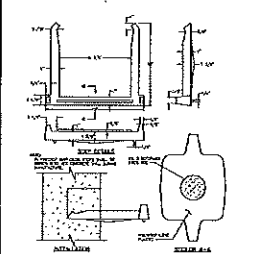

POLYPROPYLENE MANHOLE STEPS

| | |
|--|-------------------------|
| PROJECT INFORMATION | |
| STONE RISE | |
| DESIGNED BY: | DATE: |
| CHECKED BY: | SCALE: |
| APPROVALS: | |
| DESIGNER: | CHECKER: |
| PROJECT NO.: | SHEET NO.: |
| REVISIONS: | |
| NO. | DESCRIPTION |
| 1 | ISSUED FOR PERMITS |
| 2 | ISSUED FOR CONSTRUCTION |
| PRELIMINARY & FINAL MAJOR SITE PLAN | |
| CONSTRUCTION DETAILS | |

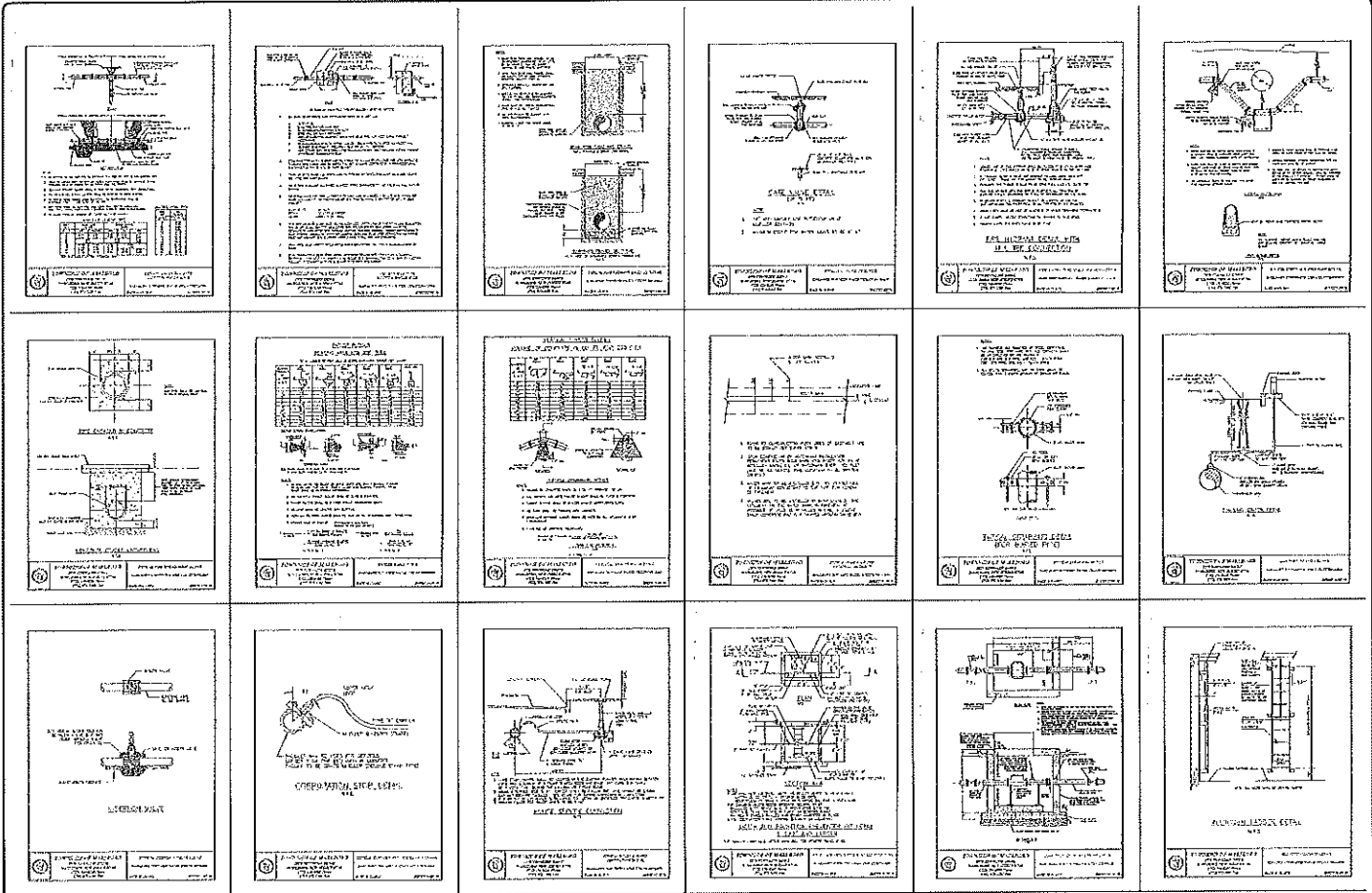

PROJECT INFORMATION

STONE RISE

CLIENT: [Name]

ARCHITECT: [Name]

ENGINEER: [Name]

PROFESSIONAL SEAL

REGISTERED PROFESSIONAL ENGINEER

STATE OF [State]

NO. [Number]

NOTES:

1. SEE ARCHITECT'S DRAWINGS FOR GENERAL NOTES.
2. ALL MATERIALS TO BE APPROVED BY THE ARCHITECT.
3. ALL WORK TO BE DONE IN ACCORDANCE WITH THE SPECIFICATIONS.
4. ALL WORK TO BE DONE IN ACCORDANCE WITH THE LOCAL CODES.

REVISIONS

| NO. | DESCRIPTION | DATE |
|-----|-------------|------|
| | | |
| | | |
| | | |

PRELIMINARY & FINAL MAJOR SITE PLAN

CONSTRUCTION DETAILS

C891

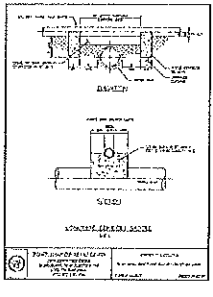
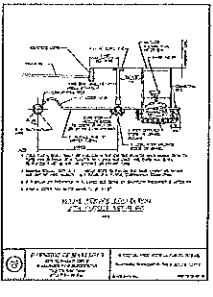
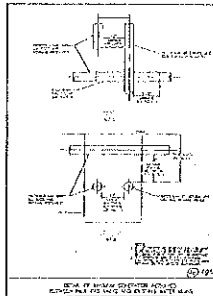
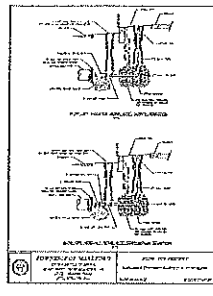
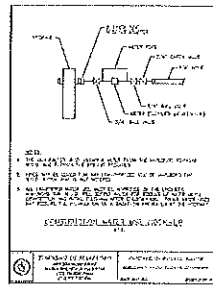
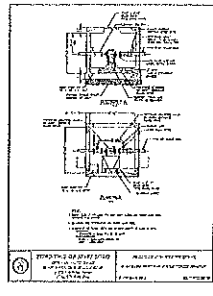
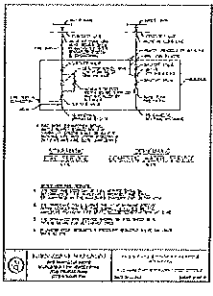

BARBORS TOWNSHIP
UNINCORPORATED TOWNSHIP
Plan No. 11

| NO. | DATE | DESCRIPTION | BY |
|-----|--------|-------------|-----|
| 1 | 1/1/20 | ... | ... |
| 2 | ... | ... | ... |
| 3 | ... | ... | ... |
| 4 | ... | ... | ... |
| 5 | ... | ... | ... |
| 6 | ... | ... | ... |
| 7 | ... | ... | ... |
| 8 | ... | ... | ... |

BARBORS TOWNSHIP
UNINCORPORATED TOWNSHIP
Plan No. 11

| NO. | DATE | DESCRIPTION | BY |
|-----|------|-------------|-----|
| 1 | ... | ... | ... |
| 2 | ... | ... | ... |
| 3 | ... | ... | ... |
| 4 | ... | ... | ... |
| 5 | ... | ... | ... |
| 6 | ... | ... | ... |
| 7 | ... | ... | ... |
| 8 | ... | ... | ... |

BARBORS TOWNSHIP
UNINCORPORATED TOWNSHIP
Plan No. 11

| NO. | DATE | DESCRIPTION | BY |
|-----|------|-------------|-----|
| 1 | ... | ... | ... |
| 2 | ... | ... | ... |
| 3 | ... | ... | ... |
| 4 | ... | ... | ... |
| 5 | ... | ... | ... |
| 6 | ... | ... | ... |
| 7 | ... | ... | ... |
| 8 | ... | ... | ... |

PROJECT INFORMATION

STONE RISE

NO. 1

DATE: 1/1/20

DESIGNED BY: [Name]

PREPARED BY: [Name]

PROFESSIONALS

IN-SITE

Che Walker

REVISIONS

| NO. | DATE | DESCRIPTION |
|-----|--------|-------------|
| 1 | 1/1/20 | ... |
| 2 | ... | ... |
| 3 | ... | ... |
| 4 | ... | ... |
| 5 | ... | ... |

CONSTRUCTION DETAILS

6365

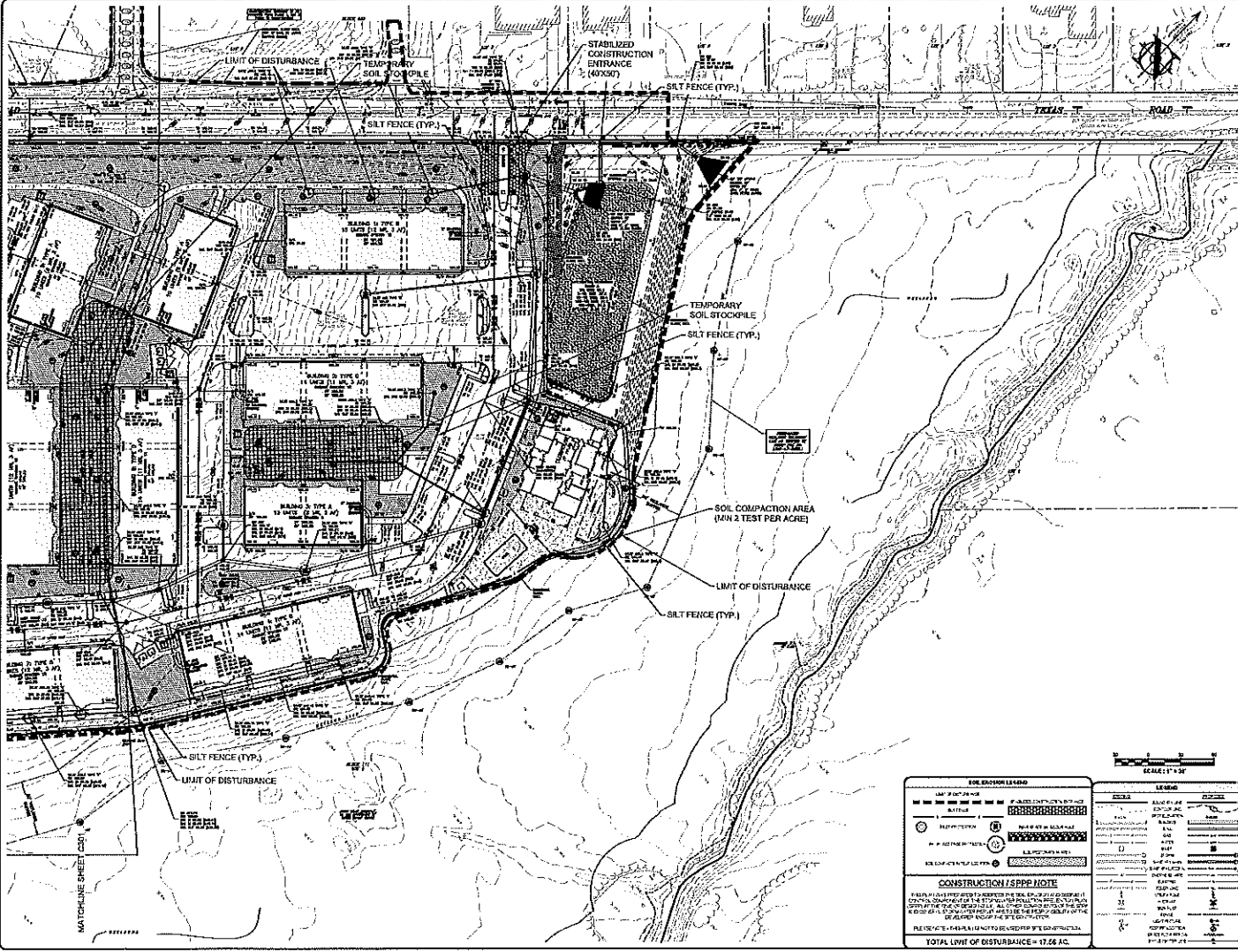

PROJECT INFORMATION
STONE RISE
 LOCATION: [BLANK]
 OWNER: [BLANK]
 CONTRACT NO.: [BLANK]
 PREPARED BY: [BLANK]
 DATE: [BLANK]
 SCALE: [BLANK]
 SHEET NO.: [BLANK]

APPLICANT'S PROFESSIONAL SEAL

 PROFESSIONAL ENGINEER
 STATE OF ALABAMA
 NO. [BLANK]
 EXPIRES [BLANK]

DESIGNER'S PROFESSIONAL SEAL

 PROFESSIONAL ENGINEER
 STATE OF ALABAMA
 NO. [BLANK]
 EXPIRES [BLANK]

REVISIONS

| NO. | DESCRIPTION |
|-----|-------------|
| | |
| | |
| | |
| | |
| | |

CONSTRUCTION / SPPP NOTE
 THIS PLAN IS TO BE USED TO PERFORM THE SPPP AS REQUIRED BY SECTION 10-2-1-1, CHAPTER 2-1-1 OF THE ENVIRONMENTAL QUALITY ACT (EQA), ALABAMA. ALL OTHER REQUIREMENTS OF THE SPPP AND ALL OTHER REGULATIONS OF THE EPCRA, CWA, CAA, AND RCRA SHALL APPLY TO THIS PROJECT AND SHALL BE ENFORCED BY THE EPCRA.
 THE TOTAL DISTURBANCE AREA IS 17.56 AC.

LEGEND

| SYMBOL | DESCRIPTION |
|--------|-------------|
| | |
| | |
| | |
| | |
| | |
| | |
| | |
| | |
| | |
| | |
| | |

PRELIMINARY & FINAL
 MAJOR SITE PLAN
 SOIL EROSION &
 SEDIMENT CONTROL
 PLAN

D550

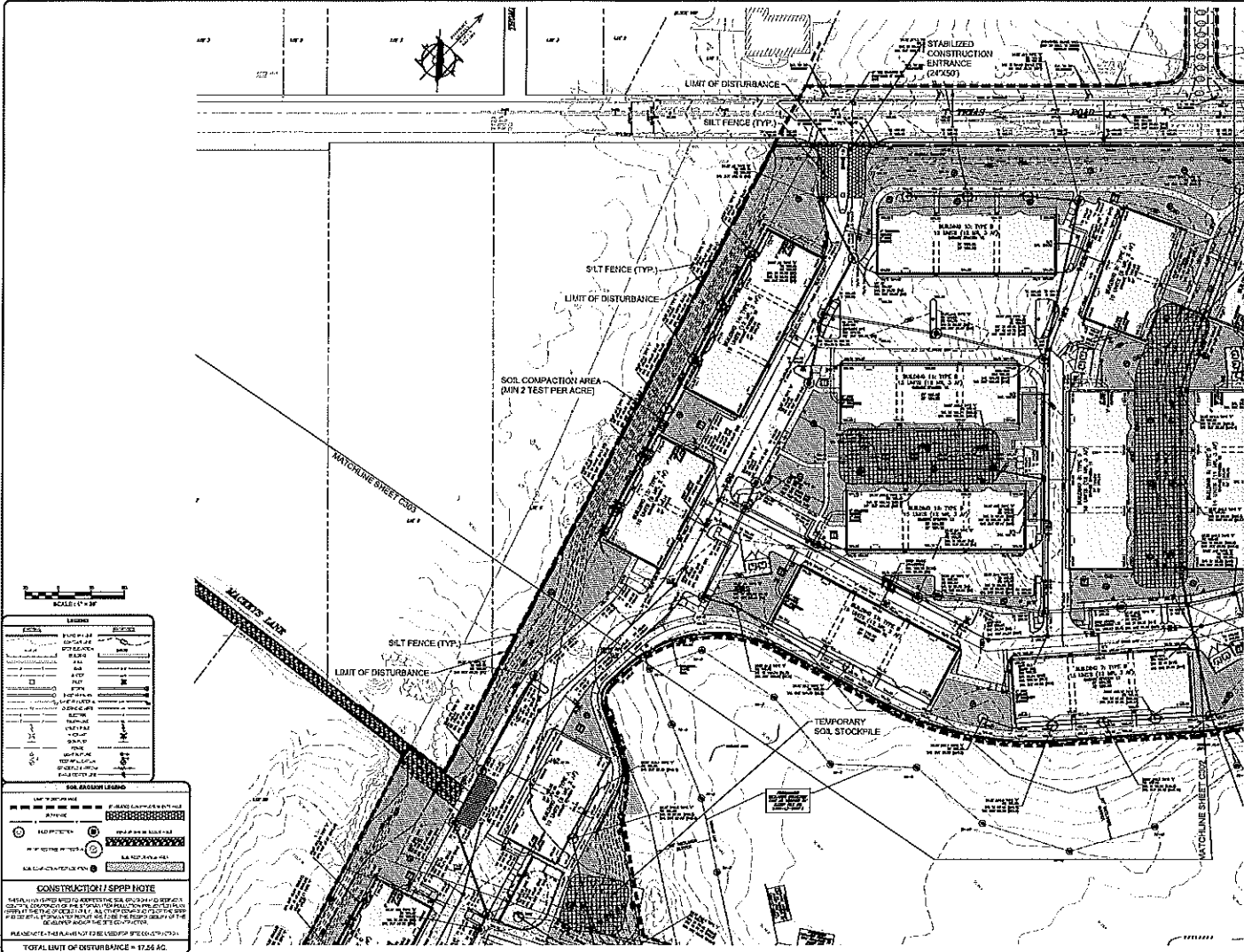

SCALE: 1" = 50'

| SYMBOL | DESCRIPTION |
|----------|--------------------------------|
| (Symbol) | EXISTING ROADWAY |
| (Symbol) | PROPOSED ROADWAY |
| (Symbol) | EXISTING UTILITY |
| (Symbol) | PROPOSED UTILITY |
| (Symbol) | EXISTING CONSTRUCTION ENTRANCE |
| (Symbol) | PROPOSED CONSTRUCTION ENTRANCE |
| (Symbol) | EXISTING SILT FENCE |
| (Symbol) | PROPOSED SILT FENCE |
| (Symbol) | EXISTING LIMIT OF DISTURBANCE |
| (Symbol) | PROPOSED LIMIT OF DISTURBANCE |
| (Symbol) | EXISTING SOIL STOCKPILE |
| (Symbol) | PROPOSED SOIL STOCKPILE |
| (Symbol) | EXISTING SOIL COMPACTION AREA |
| (Symbol) | PROPOSED SOIL COMPACTION AREA |

CONSTRUCTION / SPPP NOTE

ALL SOIL STOCKPILES SHALL BE COVERED WITH A MINIMUM OF 18" OF CLEAN FILL OR A 6" MINIMUM THICKNESS OF GEOTEXTILE FABRIC OVER A MINIMUM OF 18" OF CLEAN FILL. SOIL STOCKPILES SHALL BE COVERED WITH A MINIMUM OF 18" OF CLEAN FILL OR A 6" MINIMUM THICKNESS OF GEOTEXTILE FABRIC OVER A MINIMUM OF 18" OF CLEAN FILL.

SOIL COMPACTION SHALL BE PERFORMED TO A MINIMUM OF 95% RELATIVE DENSITY (AS DETERMINED BY STANDARD TEST METHOD ASTM D1557) FOR ALL SOIL STOCKPILES AND SOIL COMPACTION AREAS.

SOIL COMPACTION SHALL BE PERFORMED TO A MINIMUM OF 95% RELATIVE DENSITY (AS DETERMINED BY STANDARD TEST METHOD ASTM D1557) FOR ALL SOIL STOCKPILES AND SOIL COMPACTION AREAS.

TOTAL LIMIT OF DISTURBANCE = 17.56 AC.

PROJECT INFORMATION

STONE RISE

PREPARED BY: [Name]
 CHECKED BY: [Name]
 DATE: [Date]

REVISIONS

| NO. | DESCRIPTION | DATE |
|-----|----------------------|------------|
| 1 | ISSUED FOR PERMIT | 01/15/2023 |
| 2 | REVISED PER COMMENTS | 01/20/2023 |

PRELIMINARY & FINAL

SOIL EROSION & SEDIMENT CONTROL PLAN

PLAN NUMBER: [Number]

DATE: [Date]

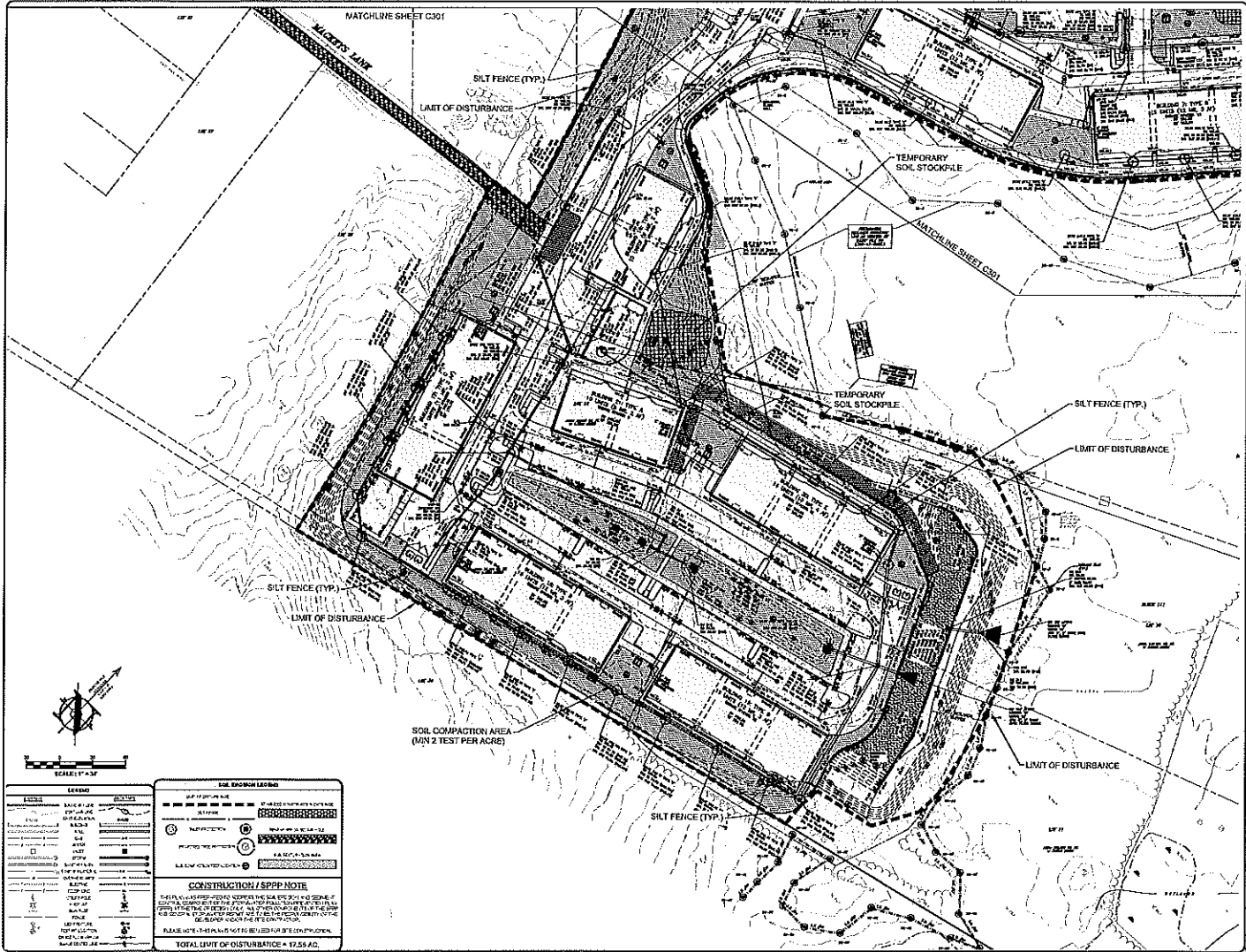

PROJECT INFORMATION

STONE RISE

PREPARED BY: [Name]

DESIGNED BY: [Name]

CHECKED BY: [Name]

DATE: [Date]

APPLICANT'S PROFESSIONALS

REGISTERED PROFESSIONAL ENGINEER: [Name]

REGISTERED PROFESSIONAL LANDSCAPE ARCHITECT: [Name]

REGISTERED PROFESSIONAL SURVEYOR: [Name]

SCALE: 1" = 40'

LOGO: [Professional Seal]

LOGO: [Company Logo]

REVISIONS

| NO. | DATE | DESCRIPTION |
|-----|------|-------------|
| | | |
| | | |
| | | |
| | | |

PRELIMINARY & FINAL MAJOR SITE PLAN

SOIL EROSION & SEDIMENT CONTROL PLAN

SCALE: 1" = 40'

DATE: [Date]

DRAWN BY: [Name]

CHECKED BY: [Name]

PROJECT NO.: C302

| SYMBOL | DESCRIPTION |
|----------|--------------------------|
| (Symbol) | EXISTING |
| (Symbol) | PROPOSED |
| (Symbol) | CONSTRUCTION / SPPP NOTE |

CONSTRUCTION / SPPP NOTE

THIS PLAN IS PREPARED UNDER THE CARE AND SUPERVISION OF THE PROFESSIONAL ENGINEER AND LANDSCAPE ARCHITECT. THE USER SHALL BE RESPONSIBLE FOR OBTAINING ALL NECESSARY PERMITS AND REGULATIONS FROM THE APPLICABLE AGENCIES. THIS PLAN IS NOT TO BE USED FOR CONSTRUCTION WITHOUT THE SIGNATURE AND SEAL OF THE PROFESSIONAL ENGINEER AND LANDSCAPE ARCHITECT.

TOTAL LIMIT OF DISTURBANCE = 97.59 AC.

GENERAL NOTES:

1. ALL DIMENSIONS ARE UNLESS OTHERWISE SPECIFIED.
2. ALL MATERIALS SHALL BE AS SPECIFIED IN THE SPECIFICATIONS.
3. ALL MATERIALS SHALL BE OF THE BEST QUALITY AVAILABLE.
4. ALL MATERIALS SHALL BE SUBJECT TO INSPECTION AND APPROVAL BY THE ENGINEER.
5. ALL MATERIALS SHALL BE SUBJECT TO TESTING AND APPROVAL BY THE ENGINEER.
6. ALL MATERIALS SHALL BE SUBJECT TO INSPECTION AND APPROVAL BY THE ENGINEER.
7. ALL MATERIALS SHALL BE SUBJECT TO TESTING AND APPROVAL BY THE ENGINEER.
8. ALL MATERIALS SHALL BE SUBJECT TO INSPECTION AND APPROVAL BY THE ENGINEER.
9. ALL MATERIALS SHALL BE SUBJECT TO TESTING AND APPROVAL BY THE ENGINEER.
10. ALL MATERIALS SHALL BE SUBJECT TO INSPECTION AND APPROVAL BY THE ENGINEER.
11. ALL MATERIALS SHALL BE SUBJECT TO TESTING AND APPROVAL BY THE ENGINEER.
12. ALL MATERIALS SHALL BE SUBJECT TO INSPECTION AND APPROVAL BY THE ENGINEER.
13. ALL MATERIALS SHALL BE SUBJECT TO TESTING AND APPROVAL BY THE ENGINEER.
14. ALL MATERIALS SHALL BE SUBJECT TO INSPECTION AND APPROVAL BY THE ENGINEER.
15. ALL MATERIALS SHALL BE SUBJECT TO TESTING AND APPROVAL BY THE ENGINEER.
16. ALL MATERIALS SHALL BE SUBJECT TO INSPECTION AND APPROVAL BY THE ENGINEER.
17. ALL MATERIALS SHALL BE SUBJECT TO TESTING AND APPROVAL BY THE ENGINEER.
18. ALL MATERIALS SHALL BE SUBJECT TO INSPECTION AND APPROVAL BY THE ENGINEER.
19. ALL MATERIALS SHALL BE SUBJECT TO TESTING AND APPROVAL BY THE ENGINEER.
20. ALL MATERIALS SHALL BE SUBJECT TO INSPECTION AND APPROVAL BY THE ENGINEER.
21. ALL MATERIALS SHALL BE SUBJECT TO TESTING AND APPROVAL BY THE ENGINEER.
22. ALL MATERIALS SHALL BE SUBJECT TO INSPECTION AND APPROVAL BY THE ENGINEER.
23. ALL MATERIALS SHALL BE SUBJECT TO TESTING AND APPROVAL BY THE ENGINEER.
24. ALL MATERIALS SHALL BE SUBJECT TO INSPECTION AND APPROVAL BY THE ENGINEER.
25. ALL MATERIALS SHALL BE SUBJECT TO TESTING AND APPROVAL BY THE ENGINEER.
26. ALL MATERIALS SHALL BE SUBJECT TO INSPECTION AND APPROVAL BY THE ENGINEER.
27. ALL MATERIALS SHALL BE SUBJECT TO TESTING AND APPROVAL BY THE ENGINEER.
28. ALL MATERIALS SHALL BE SUBJECT TO INSPECTION AND APPROVAL BY THE ENGINEER.
29. ALL MATERIALS SHALL BE SUBJECT TO TESTING AND APPROVAL BY THE ENGINEER.
30. ALL MATERIALS SHALL BE SUBJECT TO INSPECTION AND APPROVAL BY THE ENGINEER.

GENERAL NOTES:

1. ALL DIMENSIONS ARE UNLESS OTHERWISE SPECIFIED.
2. ALL MATERIALS SHALL BE AS SPECIFIED IN THE SPECIFICATIONS.
3. ALL MATERIALS SHALL BE OF THE BEST QUALITY AVAILABLE.
4. ALL MATERIALS SHALL BE SUBJECT TO INSPECTION AND APPROVAL BY THE ENGINEER.
5. ALL MATERIALS SHALL BE SUBJECT TO TESTING AND APPROVAL BY THE ENGINEER.
6. ALL MATERIALS SHALL BE SUBJECT TO INSPECTION AND APPROVAL BY THE ENGINEER.
7. ALL MATERIALS SHALL BE SUBJECT TO TESTING AND APPROVAL BY THE ENGINEER.
8. ALL MATERIALS SHALL BE SUBJECT TO INSPECTION AND APPROVAL BY THE ENGINEER.
9. ALL MATERIALS SHALL BE SUBJECT TO TESTING AND APPROVAL BY THE ENGINEER.
10. ALL MATERIALS SHALL BE SUBJECT TO INSPECTION AND APPROVAL BY THE ENGINEER.
11. ALL MATERIALS SHALL BE SUBJECT TO TESTING AND APPROVAL BY THE ENGINEER.
12. ALL MATERIALS SHALL BE SUBJECT TO INSPECTION AND APPROVAL BY THE ENGINEER.
13. ALL MATERIALS SHALL BE SUBJECT TO TESTING AND APPROVAL BY THE ENGINEER.
14. ALL MATERIALS SHALL BE SUBJECT TO INSPECTION AND APPROVAL BY THE ENGINEER.
15. ALL MATERIALS SHALL BE SUBJECT TO TESTING AND APPROVAL BY THE ENGINEER.
16. ALL MATERIALS SHALL BE SUBJECT TO INSPECTION AND APPROVAL BY THE ENGINEER.
17. ALL MATERIALS SHALL BE SUBJECT TO TESTING AND APPROVAL BY THE ENGINEER.
18. ALL MATERIALS SHALL BE SUBJECT TO INSPECTION AND APPROVAL BY THE ENGINEER.
19. ALL MATERIALS SHALL BE SUBJECT TO TESTING AND APPROVAL BY THE ENGINEER.
20. ALL MATERIALS SHALL BE SUBJECT TO INSPECTION AND APPROVAL BY THE ENGINEER.
21. ALL MATERIALS SHALL BE SUBJECT TO TESTING AND APPROVAL BY THE ENGINEER.
22. ALL MATERIALS SHALL BE SUBJECT TO INSPECTION AND APPROVAL BY THE ENGINEER.
23. ALL MATERIALS SHALL BE SUBJECT TO TESTING AND APPROVAL BY THE ENGINEER.
24. ALL MATERIALS SHALL BE SUBJECT TO INSPECTION AND APPROVAL BY THE ENGINEER.
25. ALL MATERIALS SHALL BE SUBJECT TO TESTING AND APPROVAL BY THE ENGINEER.
26. ALL MATERIALS SHALL BE SUBJECT TO INSPECTION AND APPROVAL BY THE ENGINEER.
27. ALL MATERIALS SHALL BE SUBJECT TO TESTING AND APPROVAL BY THE ENGINEER.
28. ALL MATERIALS SHALL BE SUBJECT TO INSPECTION AND APPROVAL BY THE ENGINEER.
29. ALL MATERIALS SHALL BE SUBJECT TO TESTING AND APPROVAL BY THE ENGINEER.
30. ALL MATERIALS SHALL BE SUBJECT TO INSPECTION AND APPROVAL BY THE ENGINEER.

SECTION THROUGH SOIL STOCKPILE (TYP)

| NO. | DESCRIPTION | THICKNESS | REMARKS |
|-----|---------------|-----------|---------|
| 1 | GRAVEL | 1.00 FT | |
| 2 | CRUSHED STONE | 1.00 FT | |
| 3 | CRUSHED STONE | 1.00 FT | |
| 4 | CRUSHED STONE | 1.00 FT | |
| 5 | CRUSHED STONE | 1.00 FT | |
| 6 | CRUSHED STONE | 1.00 FT | |
| 7 | CRUSHED STONE | 1.00 FT | |
| 8 | CRUSHED STONE | 1.00 FT | |
| 9 | CRUSHED STONE | 1.00 FT | |
| 10 | CRUSHED STONE | 1.00 FT | |
| 11 | CRUSHED STONE | 1.00 FT | |
| 12 | CRUSHED STONE | 1.00 FT | |
| 13 | CRUSHED STONE | 1.00 FT | |
| 14 | CRUSHED STONE | 1.00 FT | |
| 15 | CRUSHED STONE | 1.00 FT | |
| 16 | CRUSHED STONE | 1.00 FT | |
| 17 | CRUSHED STONE | 1.00 FT | |
| 18 | CRUSHED STONE | 1.00 FT | |
| 19 | CRUSHED STONE | 1.00 FT | |
| 20 | CRUSHED STONE | 1.00 FT | |

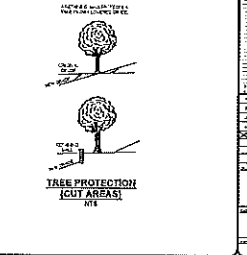
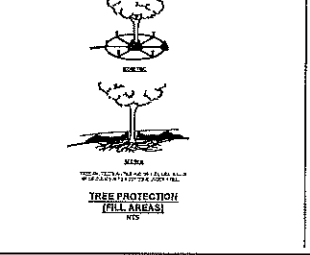
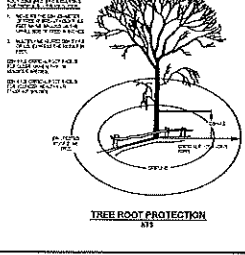
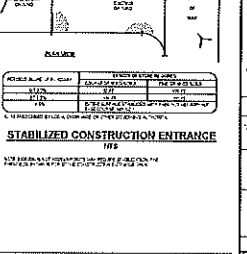
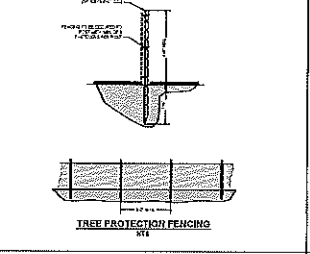
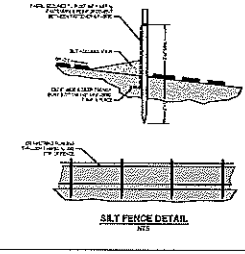
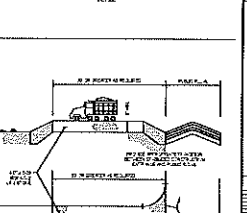
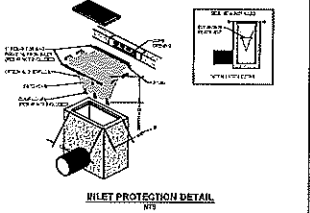
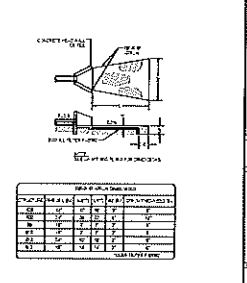
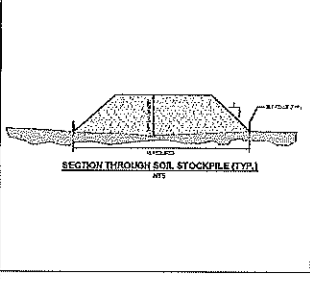

PROJECT INFORMATION

STONE RISE

DESIGNED BY: [Name]

CHECKED BY: [Name]

DATE: [Date]

SCALE: [Scale]

APPARENT PROFESSIONAL SEAL: [Seal]

REVISIONS:

| NO. | DESCRIPTION | DATE |
|-----|-------------------|------------|
| 1 | ISSUED FOR PERMIT | 11/15/2023 |
| 2 | ISSUED FOR PERMIT | 11/15/2023 |
| 3 | ISSUED FOR PERMIT | 11/15/2023 |
| 4 | ISSUED FOR PERMIT | 11/15/2023 |
| 5 | ISSUED FOR PERMIT | 11/15/2023 |
| 6 | ISSUED FOR PERMIT | 11/15/2023 |
| 7 | ISSUED FOR PERMIT | 11/15/2023 |
| 8 | ISSUED FOR PERMIT | 11/15/2023 |
| 9 | ISSUED FOR PERMIT | 11/15/2023 |
| 10 | ISSUED FOR PERMIT | 11/15/2023 |
| 11 | ISSUED FOR PERMIT | 11/15/2023 |
| 12 | ISSUED FOR PERMIT | 11/15/2023 |
| 13 | ISSUED FOR PERMIT | 11/15/2023 |
| 14 | ISSUED FOR PERMIT | 11/15/2023 |
| 15 | ISSUED FOR PERMIT | 11/15/2023 |
| 16 | ISSUED FOR PERMIT | 11/15/2023 |
| 17 | ISSUED FOR PERMIT | 11/15/2023 |
| 18 | ISSUED FOR PERMIT | 11/15/2023 |
| 19 | ISSUED FOR PERMIT | 11/15/2023 |
| 20 | ISSUED FOR PERMIT | 11/15/2023 |

PRELIMINARY & FINAL

SOIL EROSION & SEDIMENT CONTROL

DETAILS

C903

REVISIONS

1. REVISIONS

2. REVISIONS

3. REVISIONS

4. REVISIONS

5. REVISIONS

6. REVISIONS

7. REVISIONS

8. REVISIONS

9. REVISIONS

10. REVISIONS

11. REVISIONS

12. REVISIONS

13. REVISIONS

14. REVISIONS

15. REVISIONS

16. REVISIONS

17. REVISIONS

18. REVISIONS

19. REVISIONS

20. REVISIONS

21. REVISIONS

22. REVISIONS

23. REVISIONS

24. REVISIONS

25. REVISIONS

26. REVISIONS

27. REVISIONS

28. REVISIONS

29. REVISIONS

30. REVISIONS

31. REVISIONS

32. REVISIONS

33. REVISIONS

34. REVISIONS

35. REVISIONS

36. REVISIONS

37. REVISIONS

38. REVISIONS

39. REVISIONS

40. REVISIONS

41. REVISIONS

42. REVISIONS

43. REVISIONS

44. REVISIONS

45. REVISIONS

46. REVISIONS

47. REVISIONS

48. REVISIONS

49. REVISIONS

50. REVISIONS

51. REVISIONS

52. REVISIONS

53. REVISIONS

54. REVISIONS

55. REVISIONS

56. REVISIONS

57. REVISIONS

58. REVISIONS

59. REVISIONS

60. REVISIONS

61. REVISIONS

62. REVISIONS

63. REVISIONS

64. REVISIONS

65. REVISIONS

66. REVISIONS

67. REVISIONS

68. REVISIONS

69. REVISIONS

70. REVISIONS

71. REVISIONS

72. REVISIONS

73. REVISIONS

74. REVISIONS

75. REVISIONS

76. REVISIONS

77. REVISIONS

78. REVISIONS

79. REVISIONS

80. REVISIONS

81. REVISIONS

82. REVISIONS

83. REVISIONS

84. REVISIONS

85. REVISIONS

86. REVISIONS

87. REVISIONS

88. REVISIONS

89. REVISIONS

90. REVISIONS

91. REVISIONS

92. REVISIONS

93. REVISIONS

94. REVISIONS

95. REVISIONS

96. REVISIONS

97. REVISIONS

98. REVISIONS

99. REVISIONS

100. REVISIONS

REVISIONS

1. REVISIONS

2. REVISIONS

3. REVISIONS

4. REVISIONS

5. REVISIONS

6. REVISIONS

7. REVISIONS

8. REVISIONS

9. REVISIONS

10. REVISIONS

11. REVISIONS

12. REVISIONS

13. REVISIONS

14. REVISIONS

15. REVISIONS

16. REVISIONS

17. REVISIONS

18. REVISIONS

19. REVISIONS

20. REVISIONS

21. REVISIONS

22. REVISIONS

23. REVISIONS

24. REVISIONS

25. REVISIONS

26. REVISIONS

27. REVISIONS

28. REVISIONS

29. REVISIONS

30. REVISIONS

31. REVISIONS

32. REVISIONS

33. REVISIONS

34. REVISIONS

35. REVISIONS

36. REVISIONS

37. REVISIONS

38. REVISIONS

39. REVISIONS

40. REVISIONS

41. REVISIONS

42. REVISIONS

43. REVISIONS

44. REVISIONS

45. REVISIONS

46. REVISIONS

47. REVISIONS

48. REVISIONS

49. REVISIONS

50. REVISIONS

51. REVISIONS

52. REVISIONS

53. REVISIONS

54. REVISIONS

55. REVISIONS

56. REVISIONS

57. REVISIONS

58. REVISIONS

59. REVISIONS

60. REVISIONS

61. REVISIONS

62. REVISIONS

63. REVISIONS

64. REVISIONS

65. REVISIONS

66. REVISIONS

67. REVISIONS

68. REVISIONS

69. REVISIONS

70. REVISIONS

71. REVISIONS

72. REVISIONS

73. REVISIONS

74. REVISIONS

75. REVISIONS

76. REVISIONS

77. REVISIONS

78. REVISIONS

79. REVISIONS

80. REVISIONS

81. REVISIONS

82. REVISIONS

83. REVISIONS

84. REVISIONS

85. REVISIONS

86. REVISIONS

87. REVISIONS

88. REVISIONS

89. REVISIONS

90. REVISIONS

91. REVISIONS

92. REVISIONS

93. REVISIONS

94. REVISIONS

95. REVISIONS

96. REVISIONS

97. REVISIONS

98. REVISIONS

99. REVISIONS

100. REVISIONS

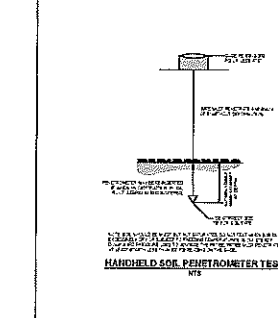
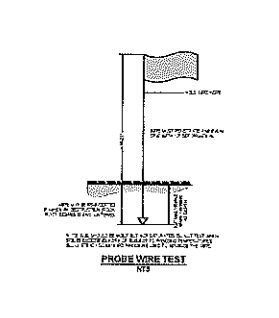
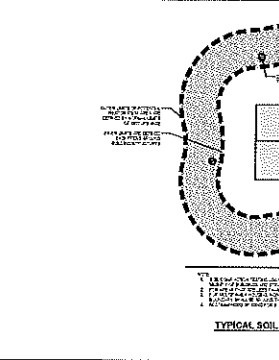

PROJECT INFORMATION

STONE RISE

REVISIONS

APPLICANT'S PROFESSIONAL SEAL

IN-SITE

Eric Miller

REVISIONS

| NO. | DATE | DESCRIPTION |
|-----|------|-------------|
| 1 | | |
| 2 | | |
| 3 | | |
| 4 | | |
| 5 | | |
| 6 | | |
| 7 | | |
| 8 | | |
| 9 | | |
| 10 | | |
| 11 | | |
| 12 | | |
| 13 | | |
| 14 | | |
| 15 | | |
| 16 | | |
| 17 | | |
| 18 | | |
| 19 | | |
| 20 | | |
| 21 | | |
| 22 | | |
| 23 | | |
| 24 | | |
| 25 | | |
| 26 | | |
| 27 | | |
| 28 | | |
| 29 | | |
| 30 | | |
| 31 | | |
| 32 | | |
| 33 | | |
| 34 | | |
| 35 | | |
| 36 | | |
| 37 | | |
| 38 | | |
| 39 | | |
| 40 | | |
| 41 | | |
| 42 | | |
| 43 | | |
| 44 | | |
| 45 | | |
| 46 | | |
| 47 | | |
| 48 | | |
| 49 | | |
| 50 | | |
| 51 | | |
| 52 | | |
| 53 | | |
| 54 | | |
| 55 | | |
| 56 | | |
| 57 | | |
| 58 | | |
| 59 | | |
| 60 | | |
| 61 | | |
| 62 | | |
| 63 | | |
| 64 | | |
| 65 | | |
| 66 | | |
| 67 | | |
| 68 | | |
| 69 | | |
| 70 | | |
| 71 | | |
| 72 | | |
| 73 | | |
| 74 | | |
| 75 | | |
| 76 | | |
| 77 | | |
| 78 | | |
| 79 | | |
| 80 | | |
| 81 | | |
| 82 | | |
| 83 | | |
| 84 | | |
| 85 | | |
| 86 | | |
| 87 | | |
| 88 | | |
| 89 | | |
| 90 | | |
| 91 | | |
| 92 | | |
| 93 | | |
| 94 | | |
| 95 | | |
| 96 | | |
| 97 | | |
| 98 | | |
| 99 | | |
| 100 | | |

PRELIMINARY & FINAL MAJOR SITE PLAN

SOIL EROSION & SEDIMENT CONTROL DETAILS

CS94